

Assembly Instructions - RSE

28.5"W x 30"H Refrigerator Support End

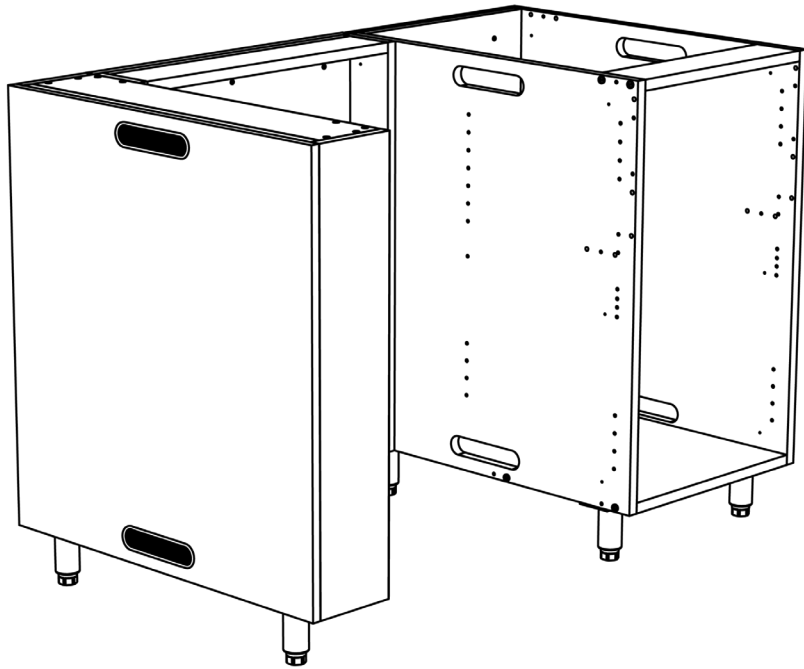

Before you start assembly, inspect all panels and hardware to ensure nothing is damaged and that you have everything required.

Required Tools

Electric Drill with square bit
3 x C-Clamp

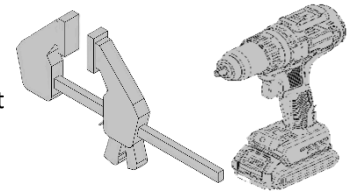

For assistance visit
Weatherstrong.com
888-845-0004

Hardware Included

Attachment Screw

X 9

H3

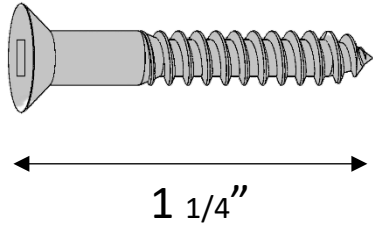

Cabinet Leg 2PK

X 1

H10

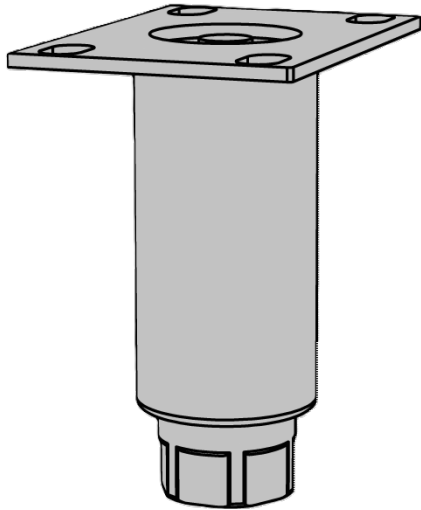

Finish Kit Pack B1 (Optional)

Matching End Panel

X 2

P

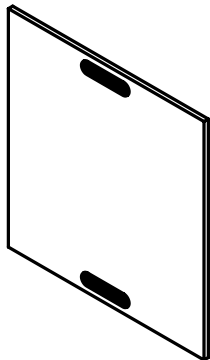

STEP 1

REQUIRES
Drill

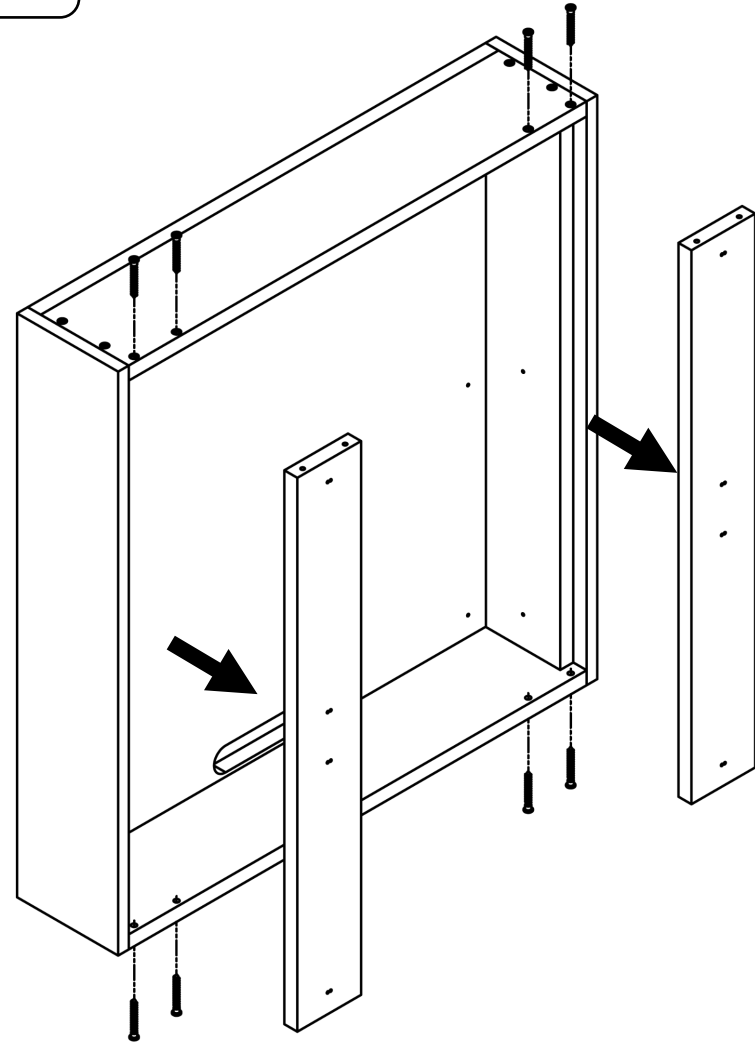

Before applying **Finished End** – remove the stiles on the **Refrigerator Support End**. This will allow you to have easier access to the holes to attach the **Panel (P)**.

STEP 2

REQUIRES

- 6 x Attachment Screw (H3)
- Drill
- 3 x C-Clamp

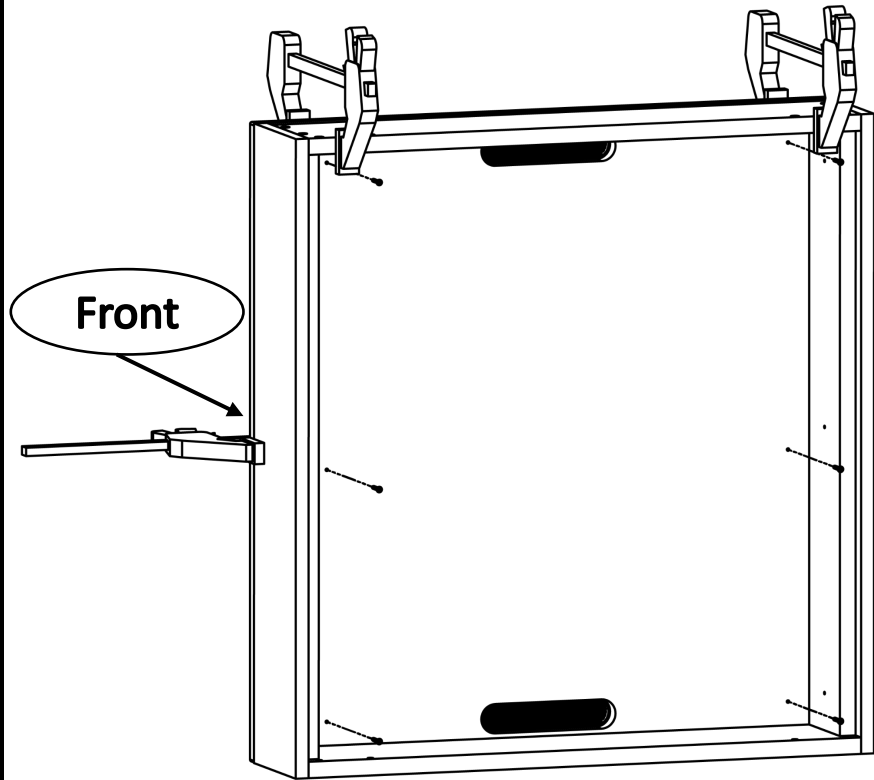

Applying Finished End – You may wish to use a C-clamp to secure panels in place while attaching. Make sure the end of **Panel (P)** is flush with the back of the **Refrigerator Support End**. Make sure the **Front** label on the **Panel (P)** matching the **Front** label on the **Refrigerator Support End**. Using the drill and 6 **Attachment screws (H3)** screw the **Refrigerator Support End** to **Panel (P)**.

STEP 3

REQUIRES

- Drill

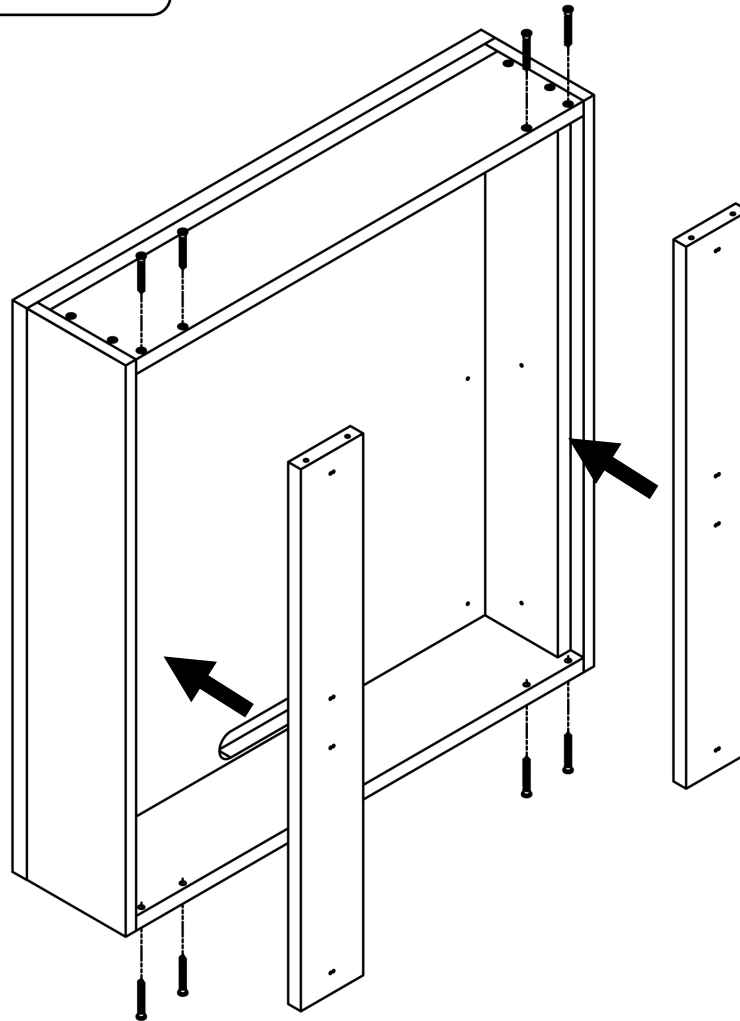

WARNING!
DO NOT
OVERTIGHTEN
FLUSH SCREW
TO PANEL

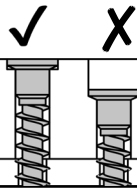

After applying Finished End – reattach the stiles on the **Refrigerator Support End** the same way you removed them.

STEP 4

REQUIRES

1 x Cabinet Leg packs (H10) &
Drill

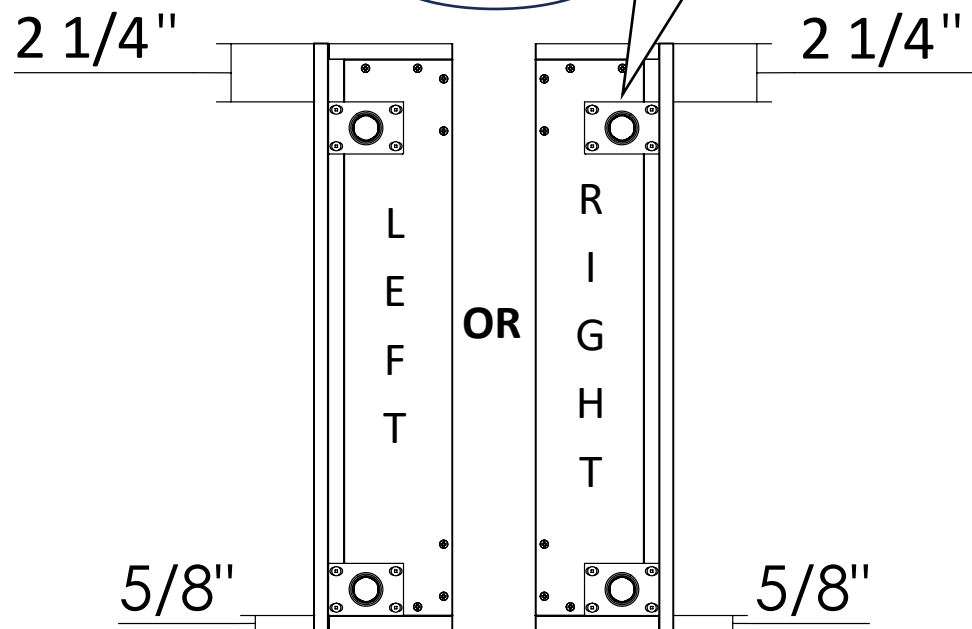

Cabinet Leg Pack (H10) consists of 2 cabinet legs, 2 cabinet leg plates and 8 screws. Depending on which side you are going to use the **Refrigerator Support End** screw front leg plate onto the **Refrigerator Support End** 2 1/4" inches from the front, and 5/8" of an inch to the sides. Screw back leg plate onto the **Refrigerator Support End** 5/8" of an inch from the back and 5/8" of an inch to the sides. Now, screw on the 2 adjustable legs.

STEP 5

REQUIRES

3 x Attachment Screw (H3)
Drill
2 x C-Clamp

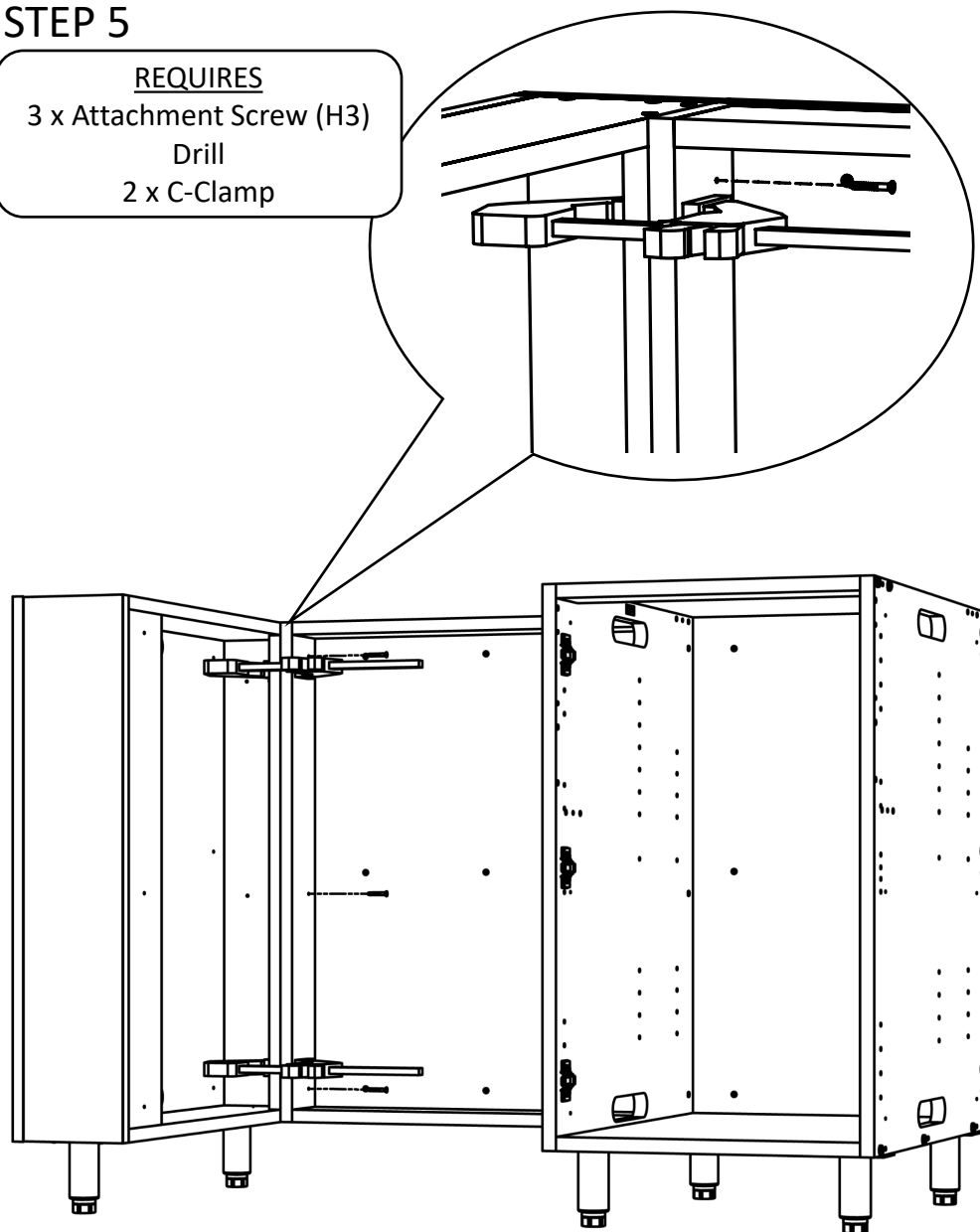

Align finished back of **Refrigerator Support End** with finished back of the **Refrigerator Backer**, use c-clamp to hold in place. Using the Drill and 3 **Attachment Screws (H3)** attach the **Refrigerator Backer** to the **Refrigerator Support End**.