

96" Tall Utility Cabinet

Assembly Guide

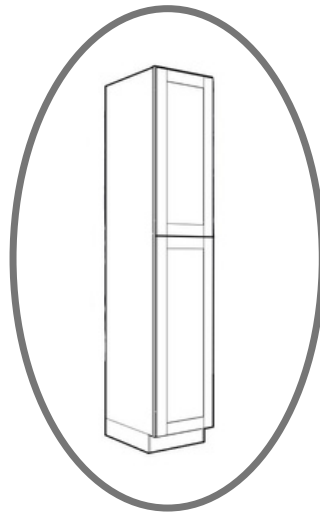

IMPORTANT NOTES

Before you start, inspect all panels and hardware to ensure you have everything needed.

We recommend laying the panels on some cardboard to protect the finish when assembling.

In addition to the pre-installed hardware, we recommend adding a bead of white wood glue in the dado grooves, to create the strongest cabinet.

96" Tall Utility Cabinet

PARTS

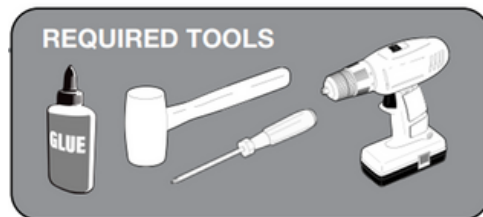
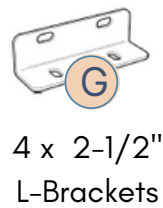
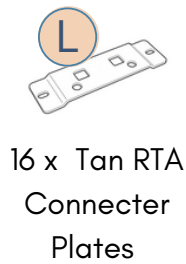
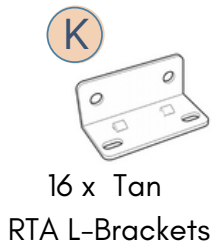
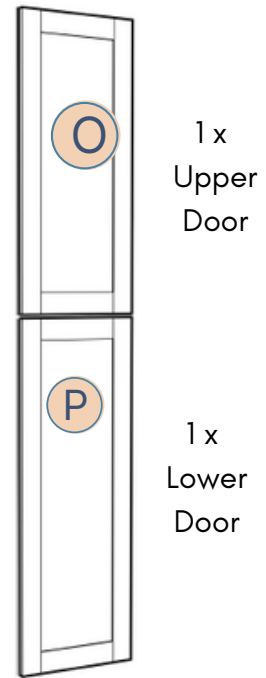
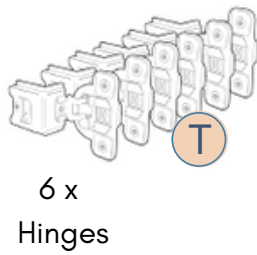
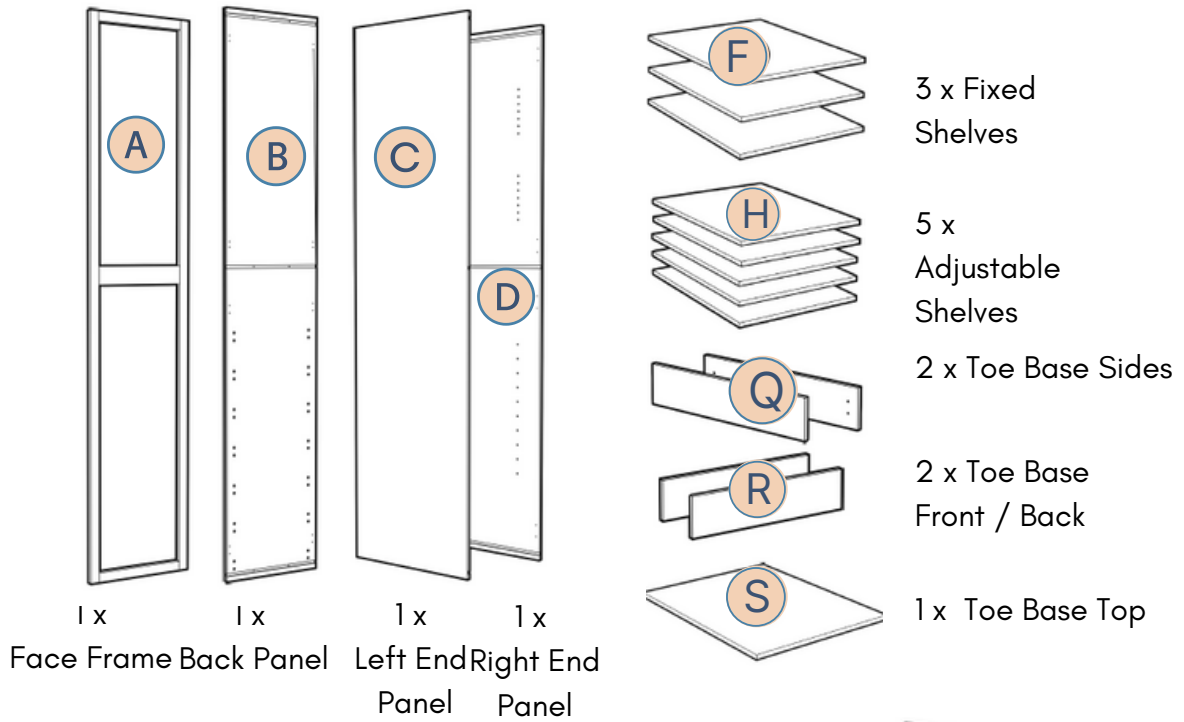

96" Tall Utility Cabinet

Step 1

Lay Frame (A) face down on a smooth flat surface, install (8) tan RTA L-Brackets (K), as shown, using (16) #6 x 1/2" Pan Head screws.

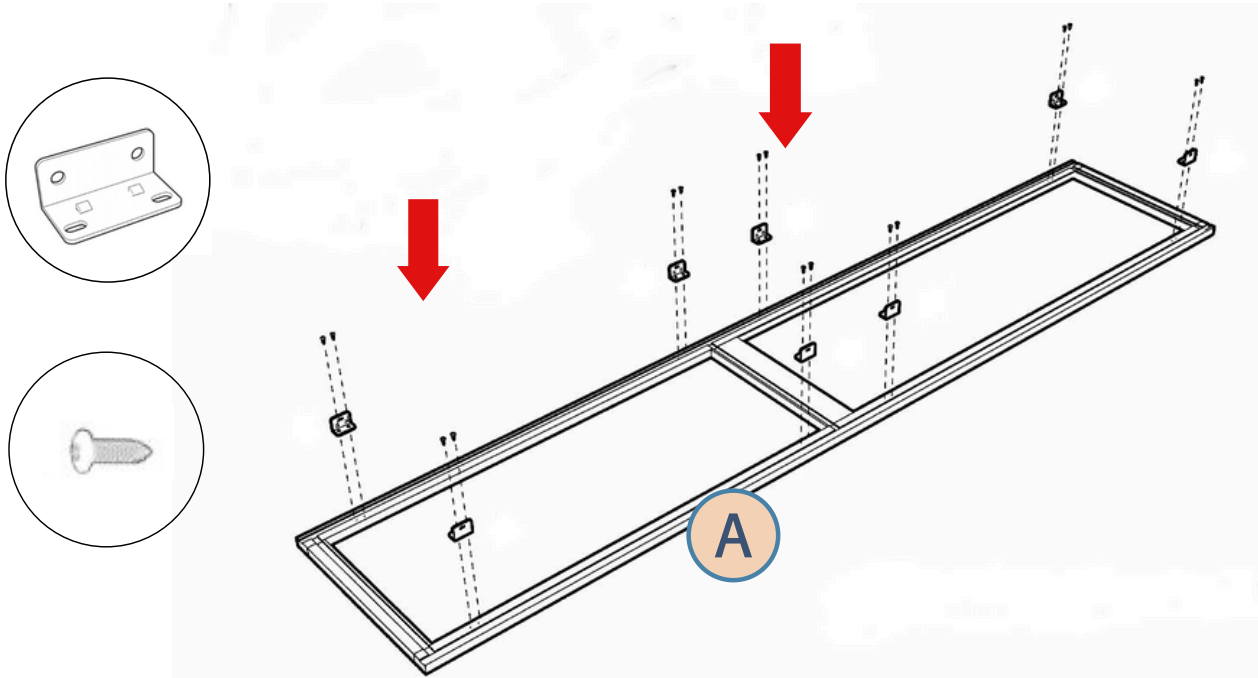

Step 2

Place Back Panel (B) on a flat smooth surface and install (8) tan RTA L-Brackets (K), as shown, using (16) #6 x 1/2" Pan Head screws.

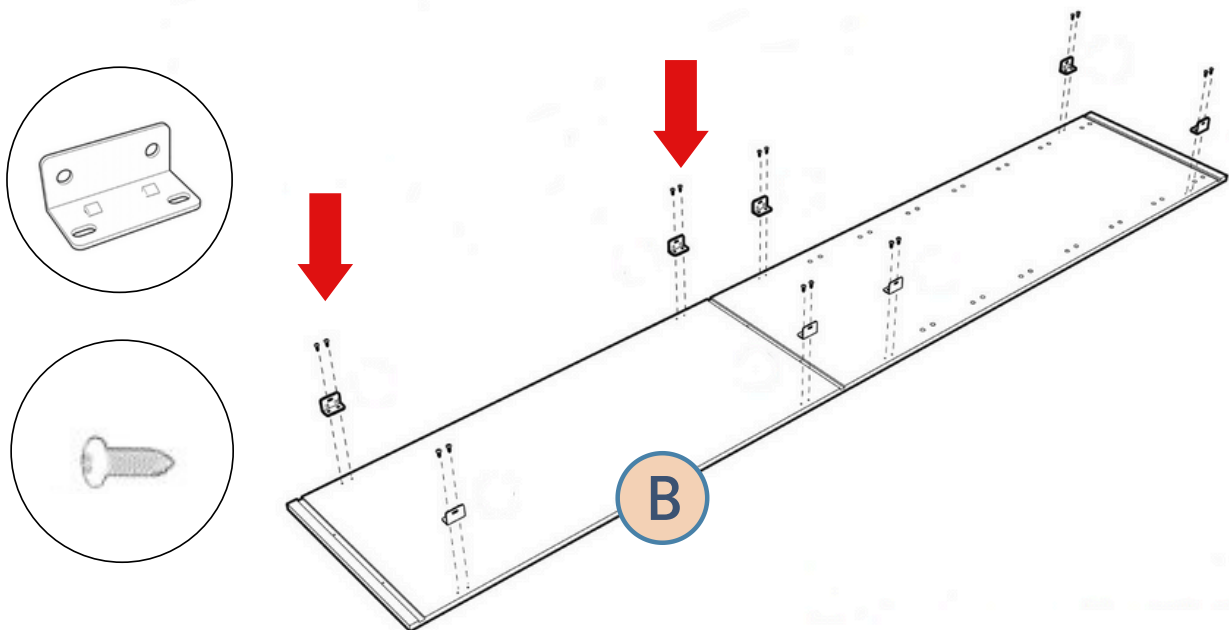

96" Tall Utility Cabinet

Step 3

Place Left and Right End Panels (C and D) on a flat smooth surface and install (16) x tan RTA Connector Plates (L), as shown, using (32) #6 x 1/2" Pan Head screws.

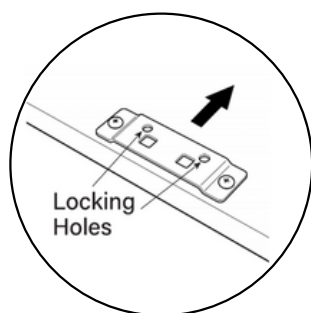
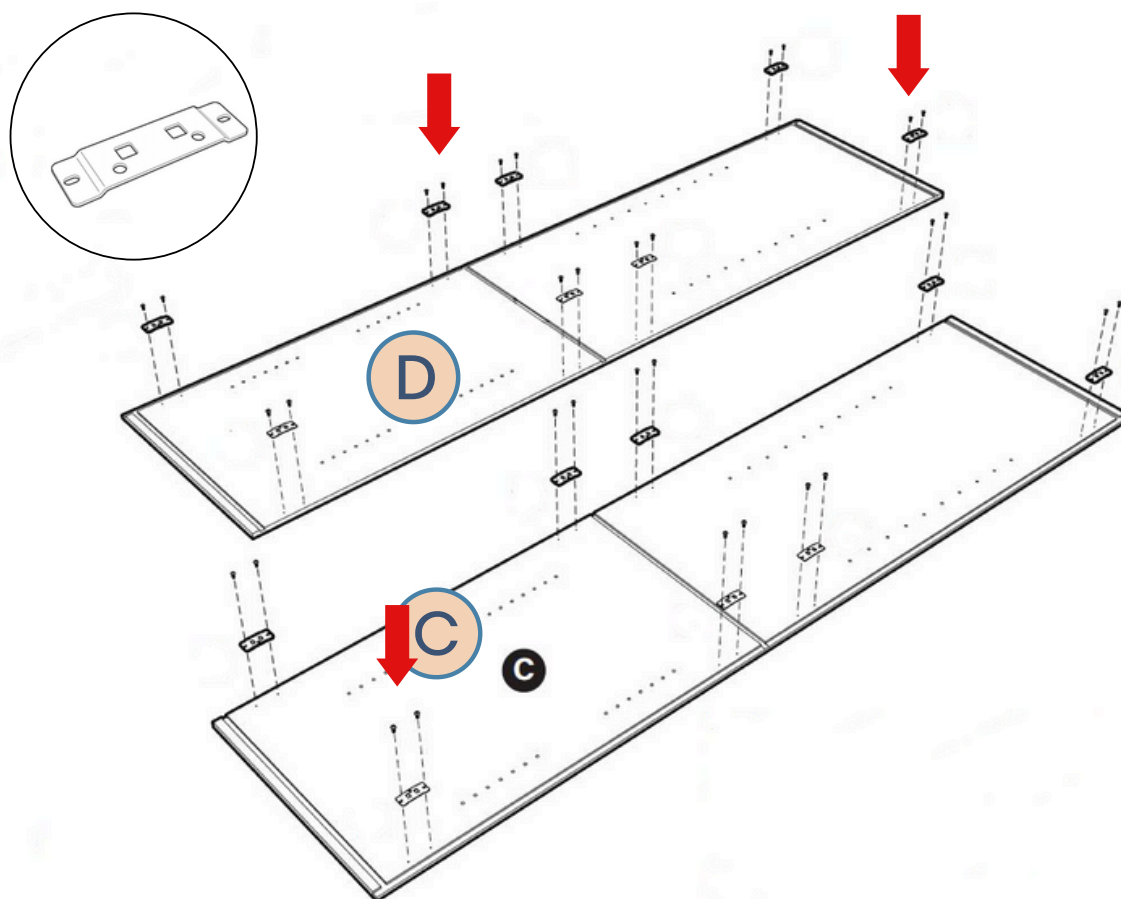

Ensure locking holes are located towards the inside of the panel.

IMPORTANT:

Do not fully tighten the screws.

The RTA Connector Plates needs to be slightly loose.

96" Tall Utility Cabinet

Step 4

Run a bead of wood glue in the grooves in the back of Frame (A) .

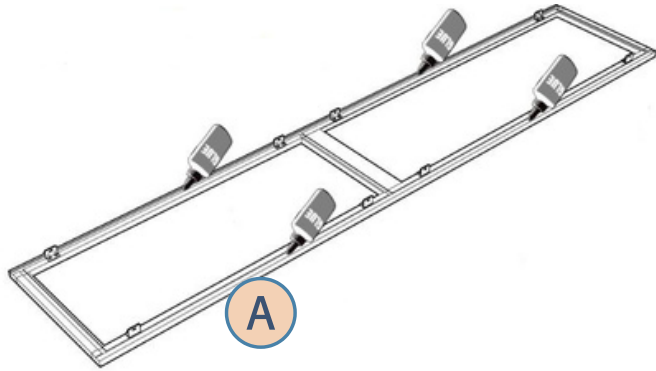

Insert End Panels (C and D) so that L-Brackets (K) and Connector Plates (L) snap together. Align the panels with the frame so that dado grooves line up.

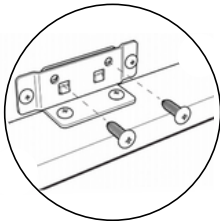
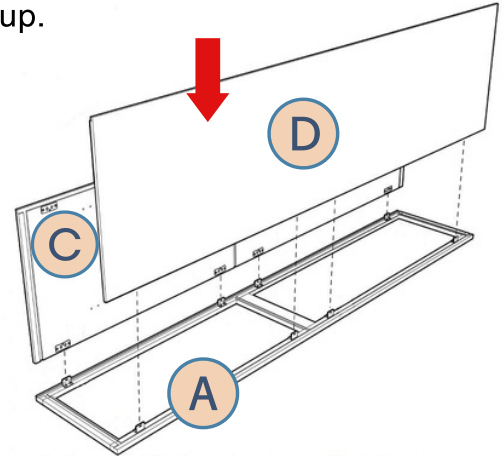

Now tighten all the Connector Plates screws and secure the Connector Plates and L-Brackets with locking screws: (16) #6 x 1/2" Pan Head.

Step 5

Run a bead of wood glue in the horizontal grooves in Frame (A) and End Panels (C and D) and insert Fixed Shelf (F) completely into the grooves.

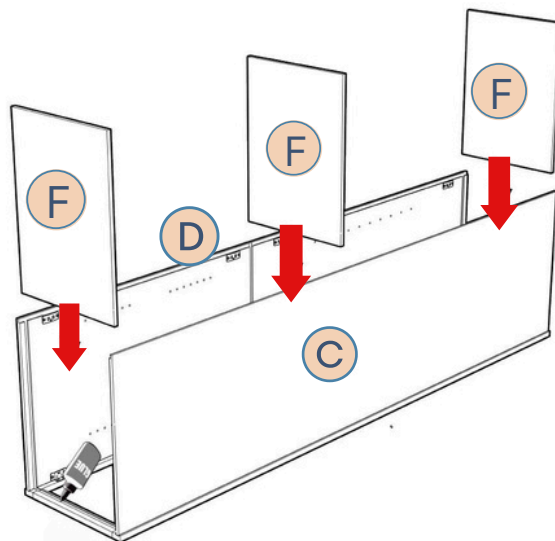

96" Tall Utility Cabinet

Step 6

Apply beads of wood glue to recesses in the back of End Panels (C and D) and horizontal grooves in the Back Panel (B).

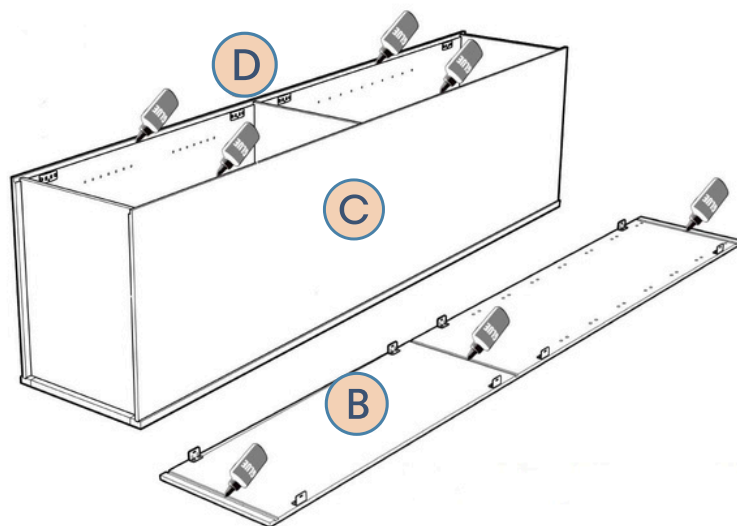

Carefully align Back Panel (B) with recesses in End Panels (C and D), so that L-Brackets (K) and Connector Plates snap together. Ensure Fixed Shelves (F) fit fully into grooves in Back Panel (B).

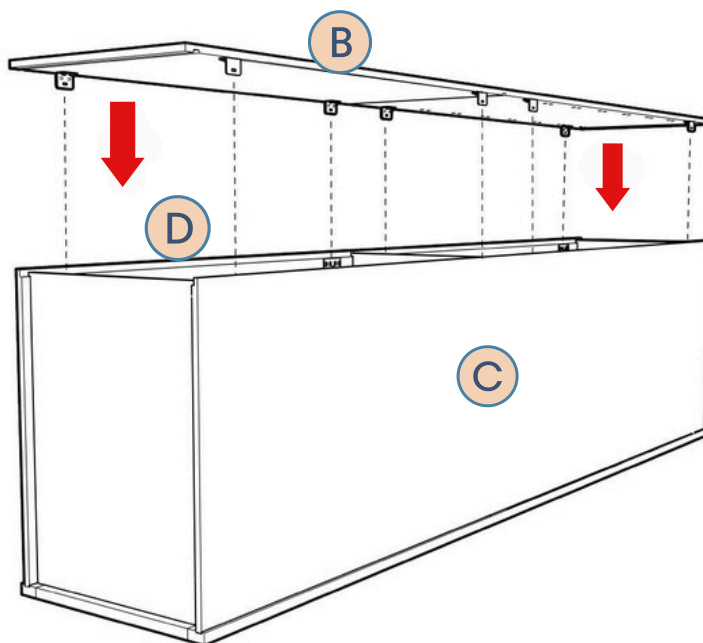

96" Tall Utility Cabinet

Step 7

Carefully turn the cabinet over, make sure it is square and secure the Connector Plates with locking screws: (16) #6 x 1/2" Pan Head.

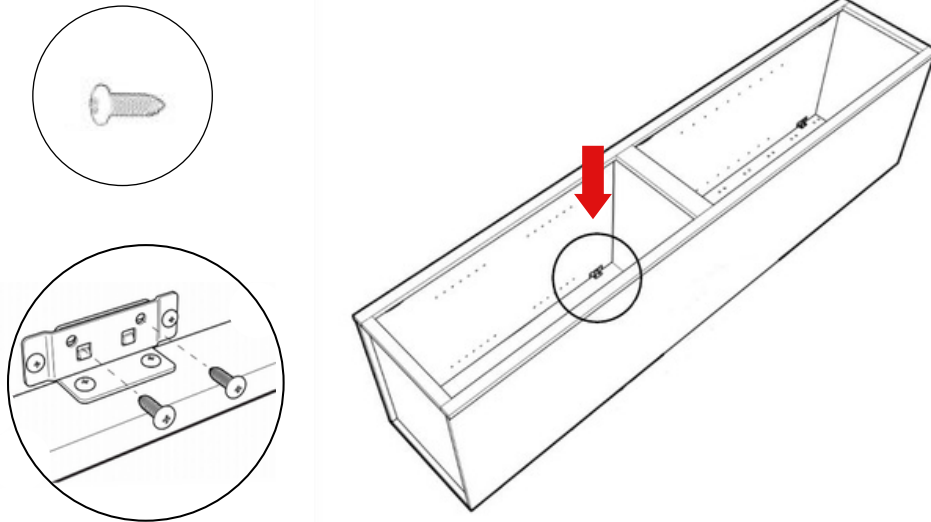

Step 8

Turn the cabinet over again, make sure it is square and insert (6) #6x 1" Flat head screws through the holes in the Back Panel (B). Tighten them into into Fixed Shelves (F).

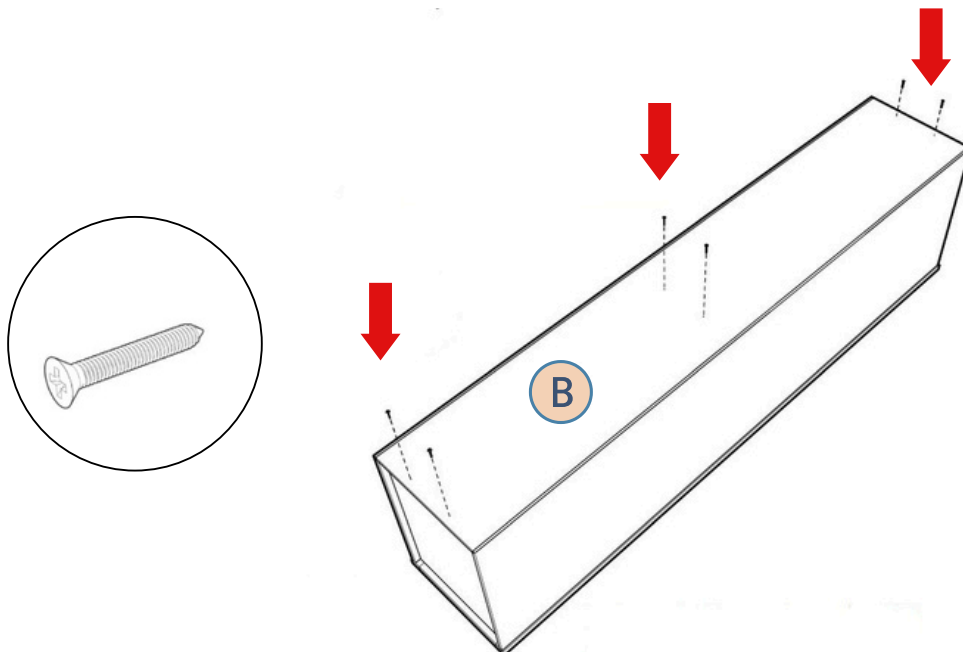

96" Tall Utility Cabinet

Step 9

Insert (20) Locking Shelf Rests (N) in desired locations and install Adjustable Shelf (H).

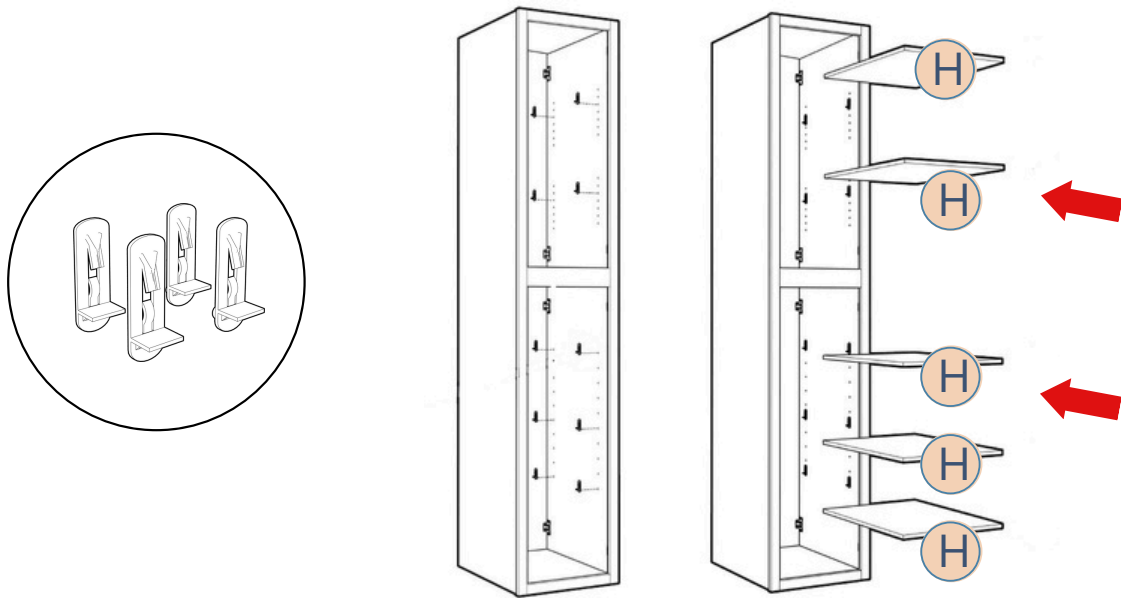

Step 10

Carefully lay the Doors (O) and (P) face down on a smooth flat surface and install (6) Hinges (T) using (12) #6 x 5/8" Flat Head screws.

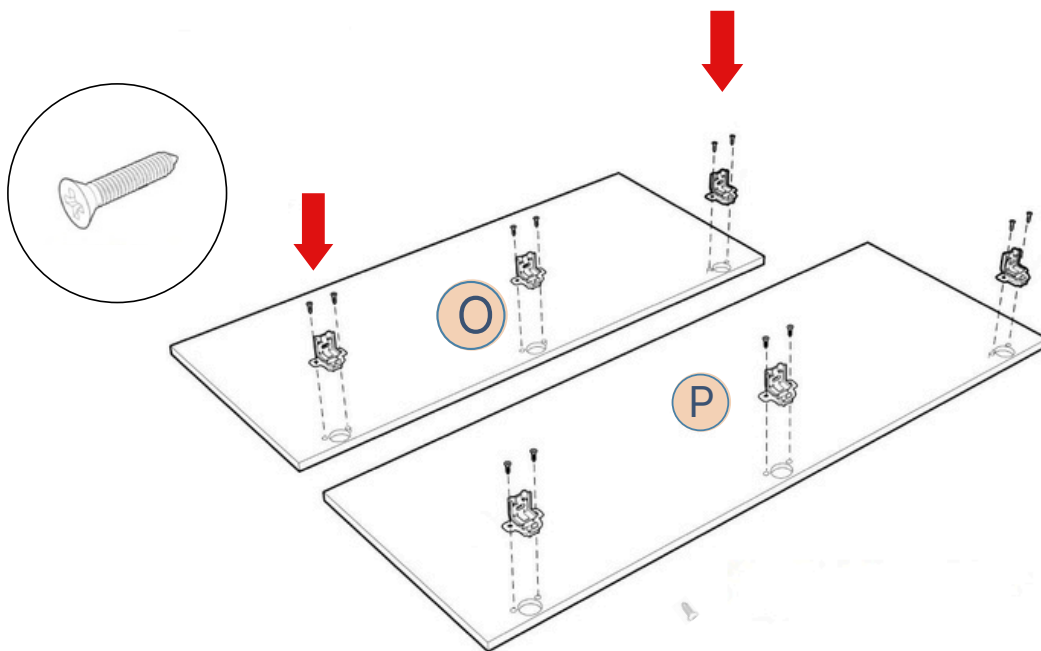

96" Tall Utility Cabinet

Step 11

Attach Upper Door (O) to the Face Frame (A) using (3) #8 x 7/8" Pan Washer Head screws and install (2) Clear Bumpers.

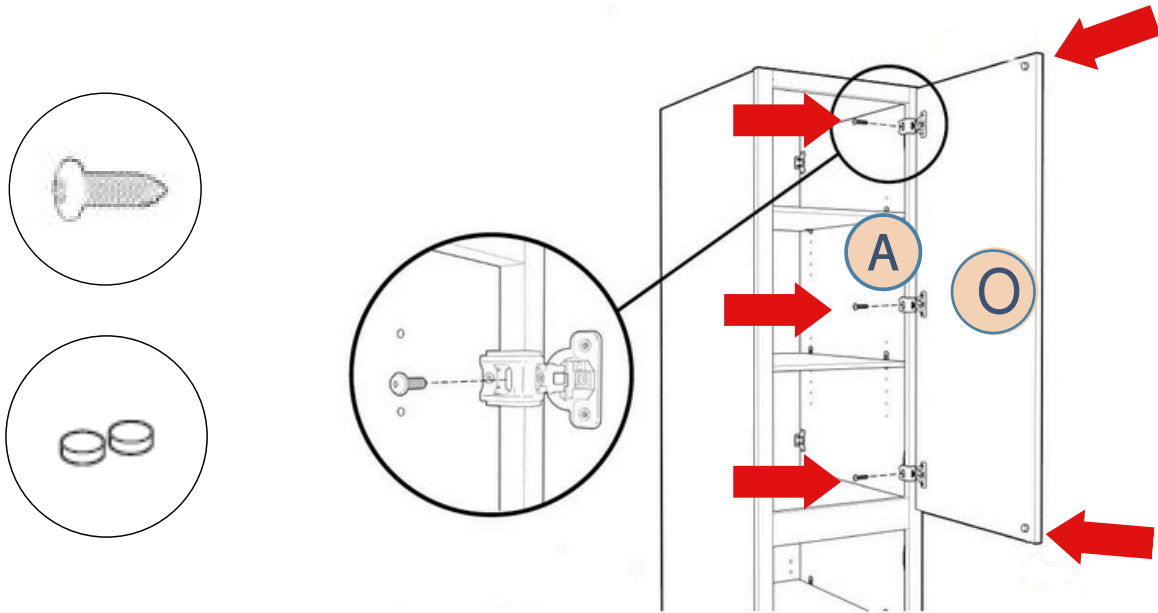

Step 12

Attach Lower Door (P) to the Face Frame (A) using (3) #8 x 7/8" Pan Washer Head screws and install (2) Clear Bumpers.

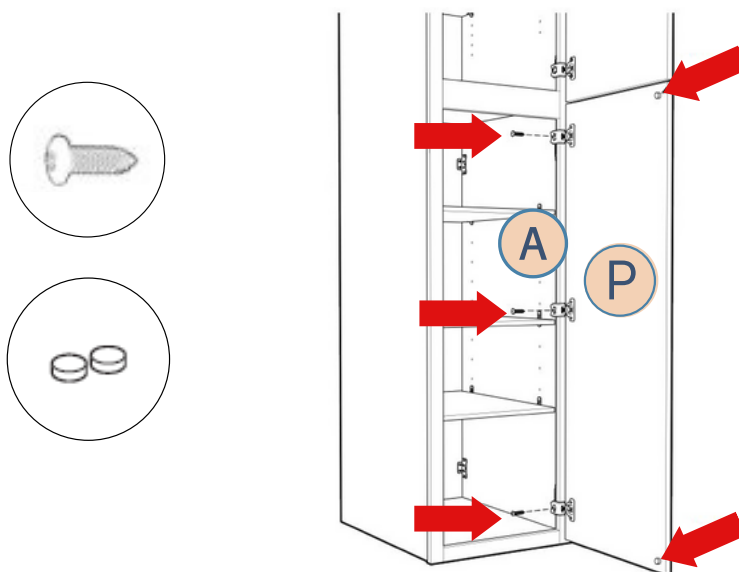

96" Tall Utility Cabinet

Step 13

Lay (2) Toe Base Sides (Q) face down on a flat surface and install (4) silver L-Brackets (G) using (8) #8 x 1/2" Pan Head screws.

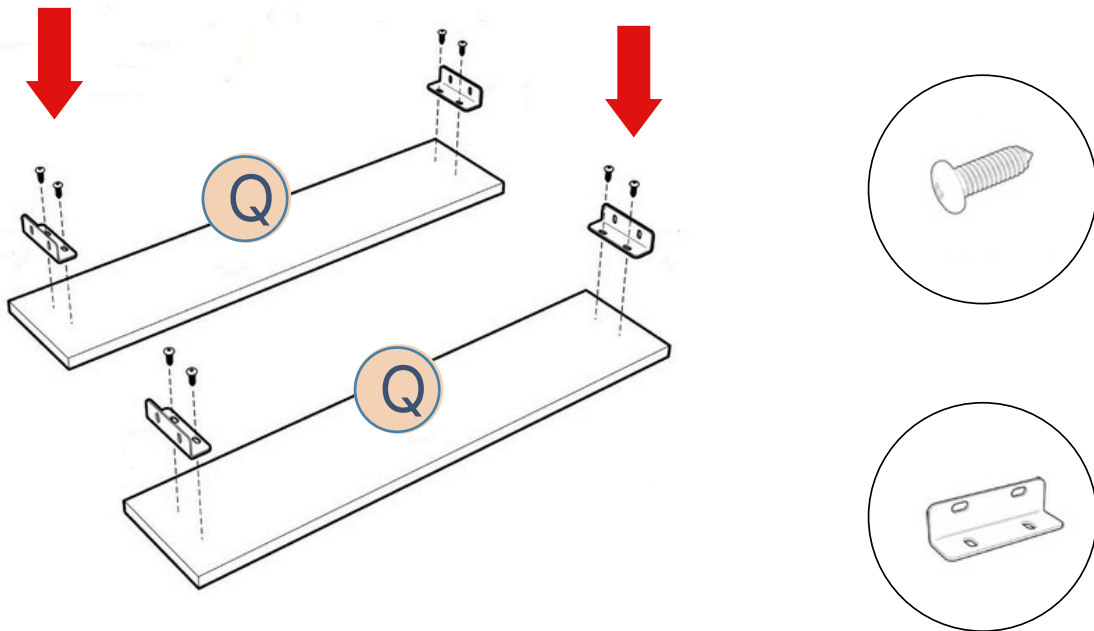

Step 14

Lay remaining Toe Base Front/Back panel on a flat surface and attach it to the Toe Base Sides (Q) using (4) #8 x 1/2" Pan Head screws.

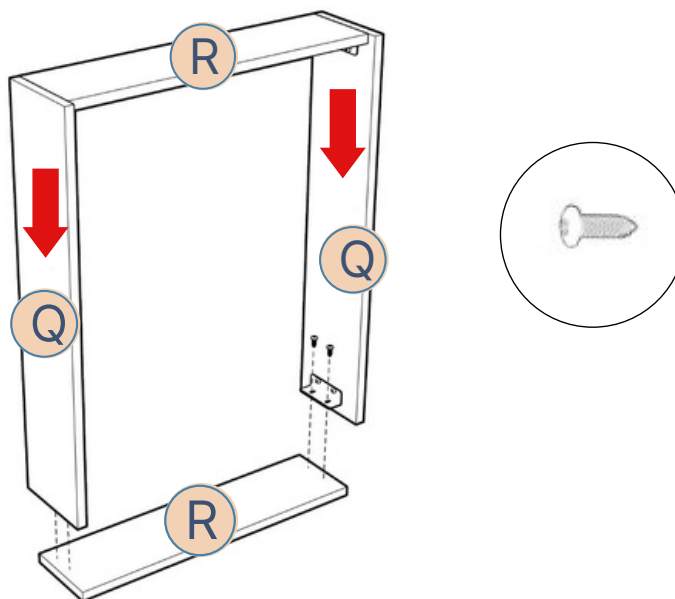

96" Tall Utility Cabinet

Step 15

Place the Toe Base Top panel (S) between the sides so they overlap the Front/Back panels and secure in place with (6) #6 x 1" Flat Head screws.

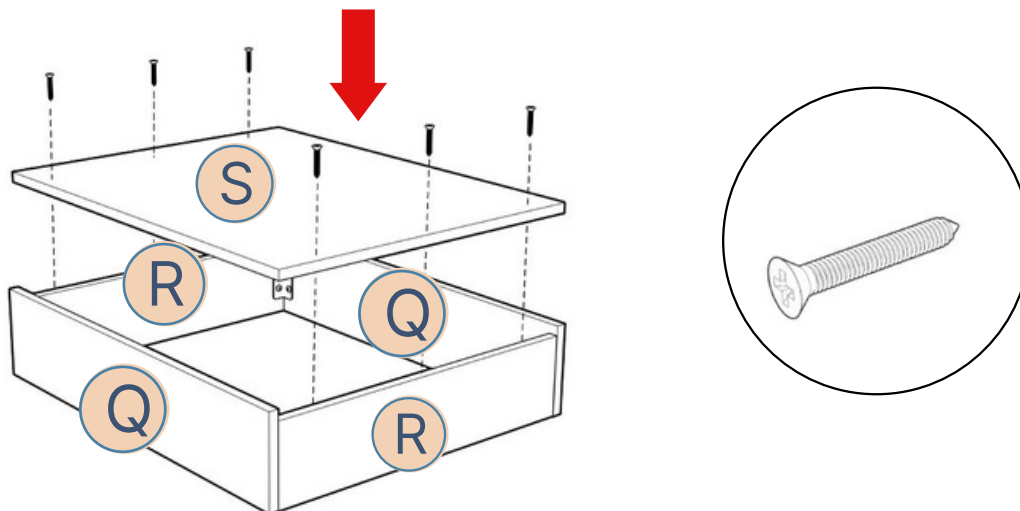

Step 16

After the Toe Base is complete, now sit the cabinet making sure the backs are aligned and attach with #6 x 1" Flat Head screws.

