

# 3 Drawer Base Cabinet

ASMBLY GUIDE BASE 3DWR



Before you start assembly, inspect all panels and hardware to ensure you have everything needed.

We recommend laying the panels on some cardboard to protect the finish when assembling.

In addition to the tan Connector Brackets supplied, we recommend that you run a bead of white wood glue into each dado groove, as you assemble, to create the strongest cabinet.

## REQUIRED TOOLS

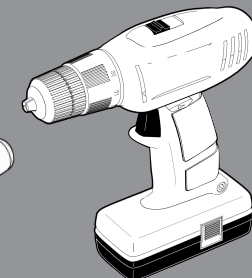
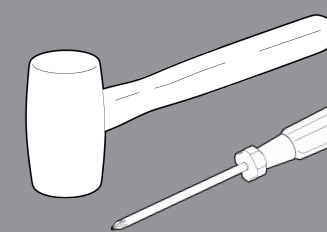

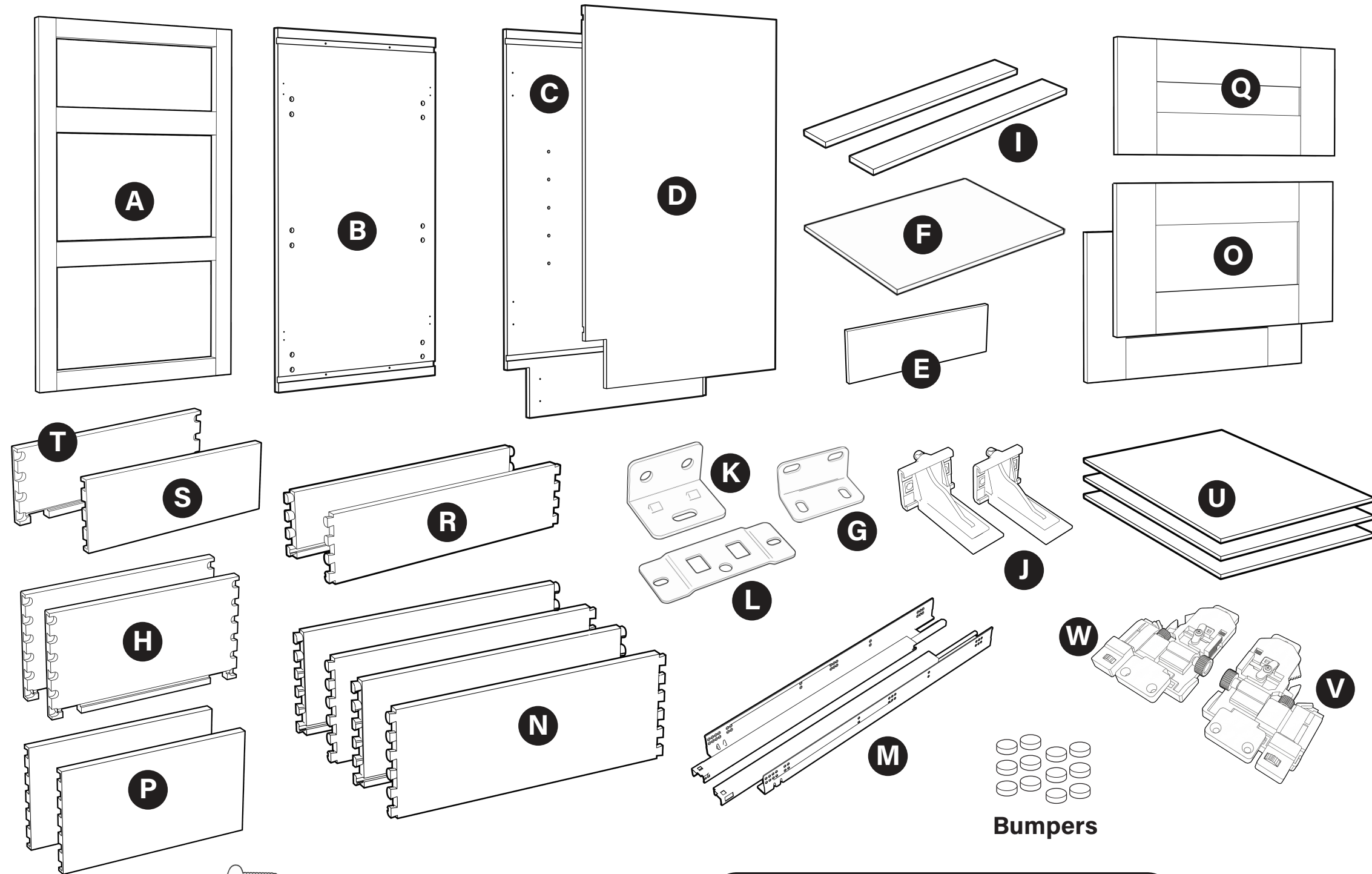

# 3 Drawer Base Cabinet

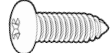
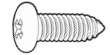
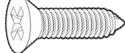

## PARTS LIST

- A** 1 x Face Frame
  - B** 1 x Back Panel
  - C** 1 x Left End Panel
  - D** 1 x Right End Panel
  - E** 1 x Integral Toe Kick
  - F** 1 x Fixed Shelf
  - G** 4 x L-Brackets
  - I** 2 x I-Beams
  - J** 6 x Runner Rear Brackets
  - K** 8 x Tan RTA L-Brackets
  - L** 8 x Tan RTA Connector Plates
  - M** 3 x Full Extension Drawer Runner Sets
  - V** 3 x Left Locking Device
  - W** 3 x Right Locking Device
- UPPER DRAWER —
- Q** 1 x Drawer front
  - R** 2 x Drawer Box Sides
  - S** 1 x Drawer Box front
  - T** 1 x Drawer Box Back
  - U** 1 x Drawer Bottom
- LOWER DRAWERS —
- O** 2 x Drawer Fronts
  - N** 4 x Drawer Box Sides
  - P** 2 x Drawer Box Fronts
  - H** 2 x Drawer Box Backs
  - U** 2 x Drawer Bottoms

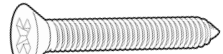
-  16 - #8 x 1/2" Pan Head Screws
-  40 - #6 x 1/2" Pan Head Screws
-  16 - #6 x 5/8" Flat Countersink Screws
-  2 - #8 x 7/8" Pan Washer Head Screws
-  4 - #6 x 1" Flat Countersink Screws

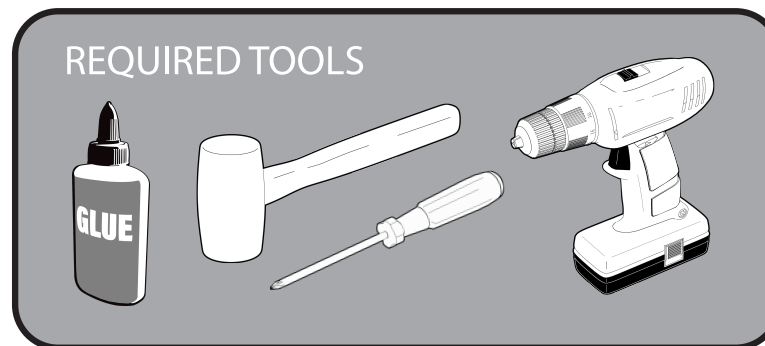

## IMPORTANT NOTES:

Before you start assembly, inspect all panels and hardware to ensure you have everything needed. In addition to the tan RTA Connector Brackets supplied, we recommend you run a bead of white wood glue into each groove as you assemble, to create the strongest cabinet. We also recommend laying the panels on some cardboard to protect the finish when assembling.

# STEP 1

## Parts List

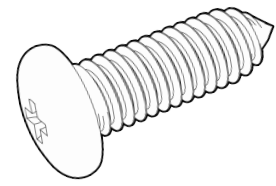

8 - #6 x 1/2" Pan Head Screws

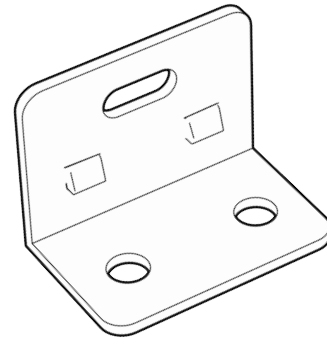

4 - Connector L-Brackets

K

TOOLS  
NEEDED

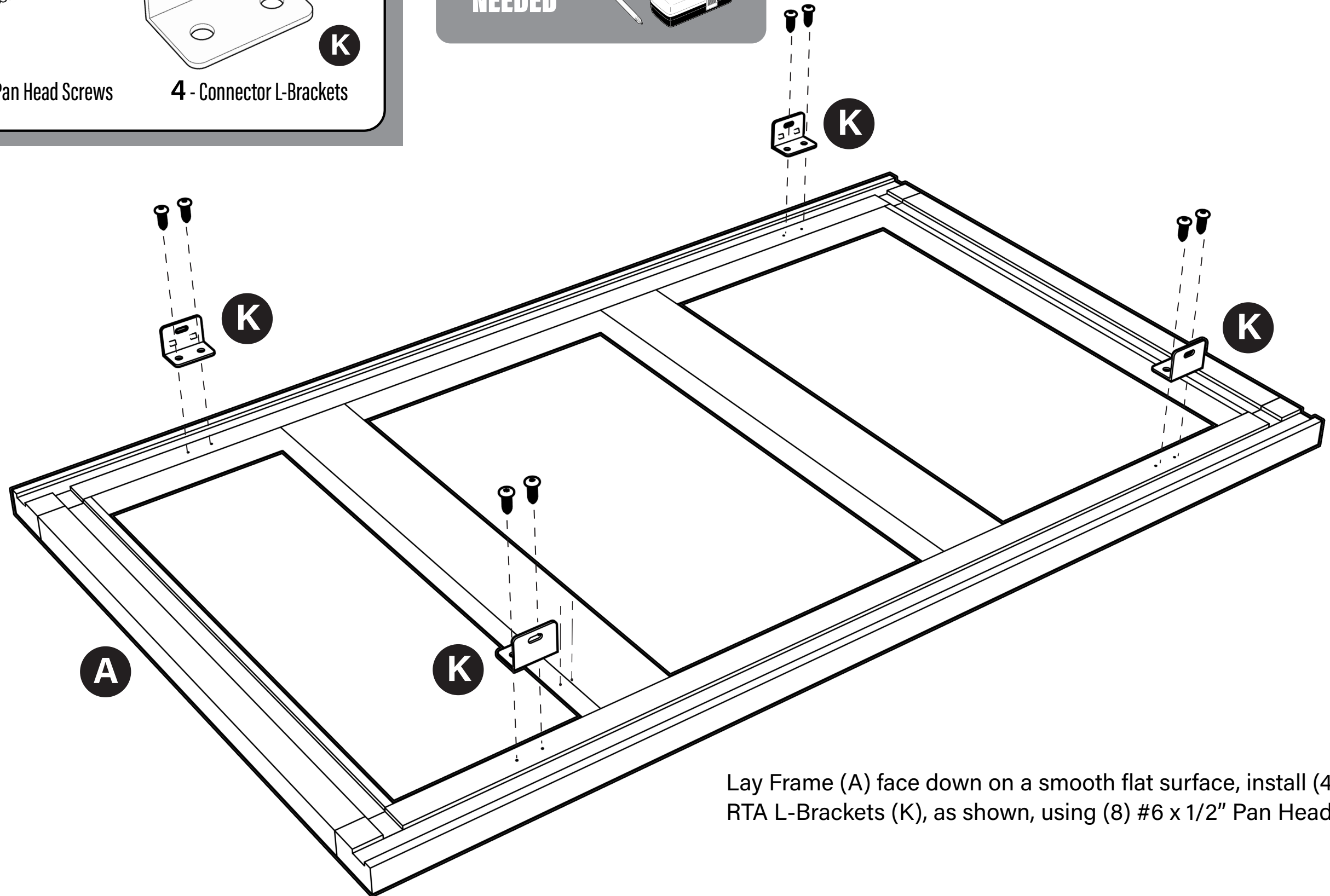
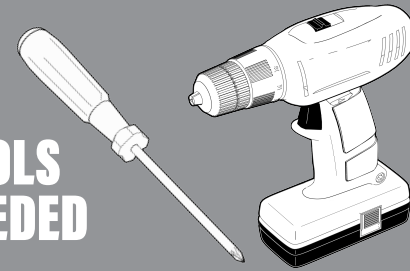

Lay Frame (A) face down on a smooth flat surface, install (4) tan RTA L-Brackets (K), as shown, using (8) #6 x 1/2" Pan Head screws.

# STEP 2

## Parts List

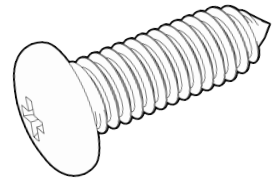

8 - #6 x 1/2" Pan Head Screws

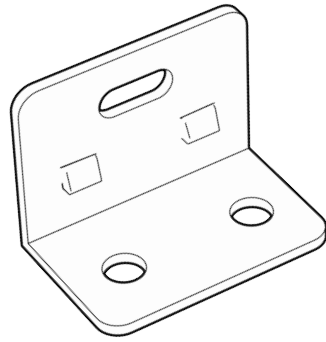

4 - Connector L-Brackets

K

TOOLS  
NEEDED

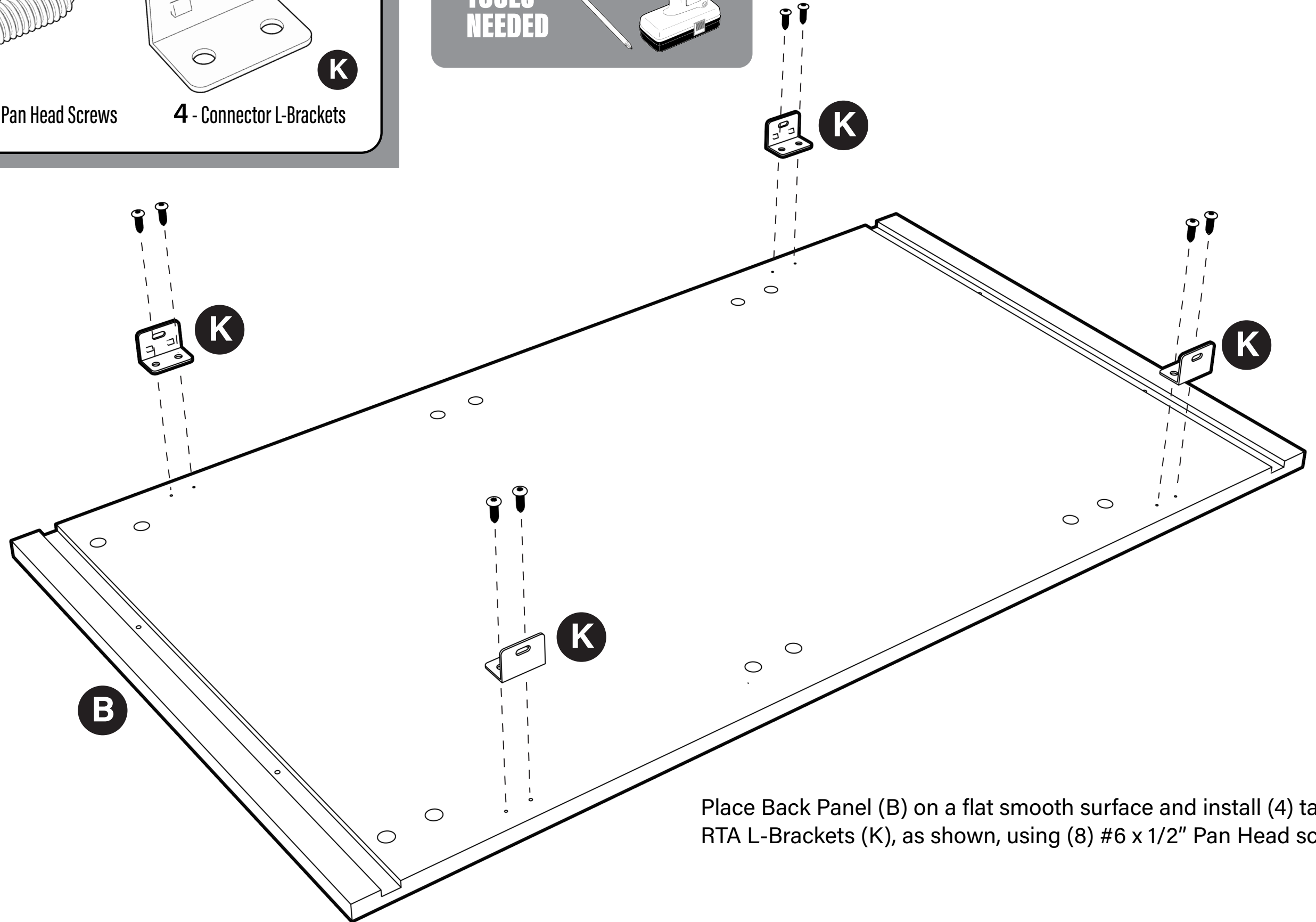
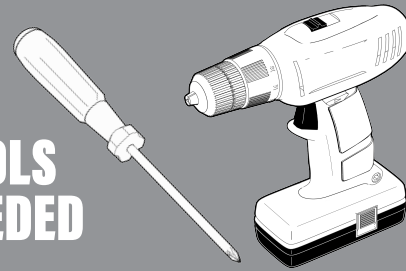

Place Back Panel (B) on a flat smooth surface and install (4) tan RTA L-Brackets (K), as shown, using (8) #6 x 1/2" Pan Head screws.

# STEP 3

## Parts List

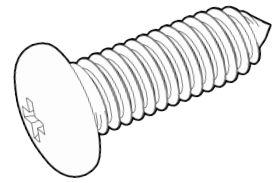

16 - #6 x 1/2" Pan Head Screws

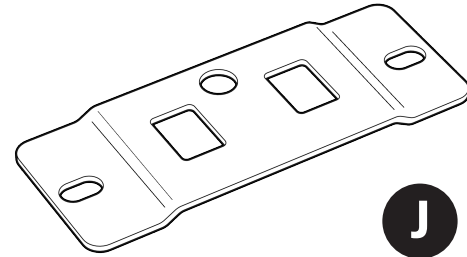

8 - Connector L-Brackets

## TOOLS NEEDED

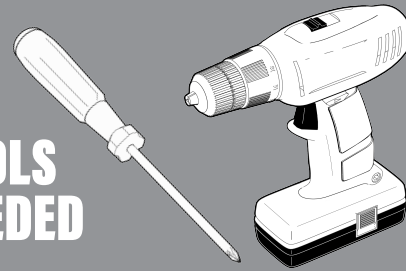

Ensure the central locking hole on the plate is located away from the edge of the panel

Central Locking Hole

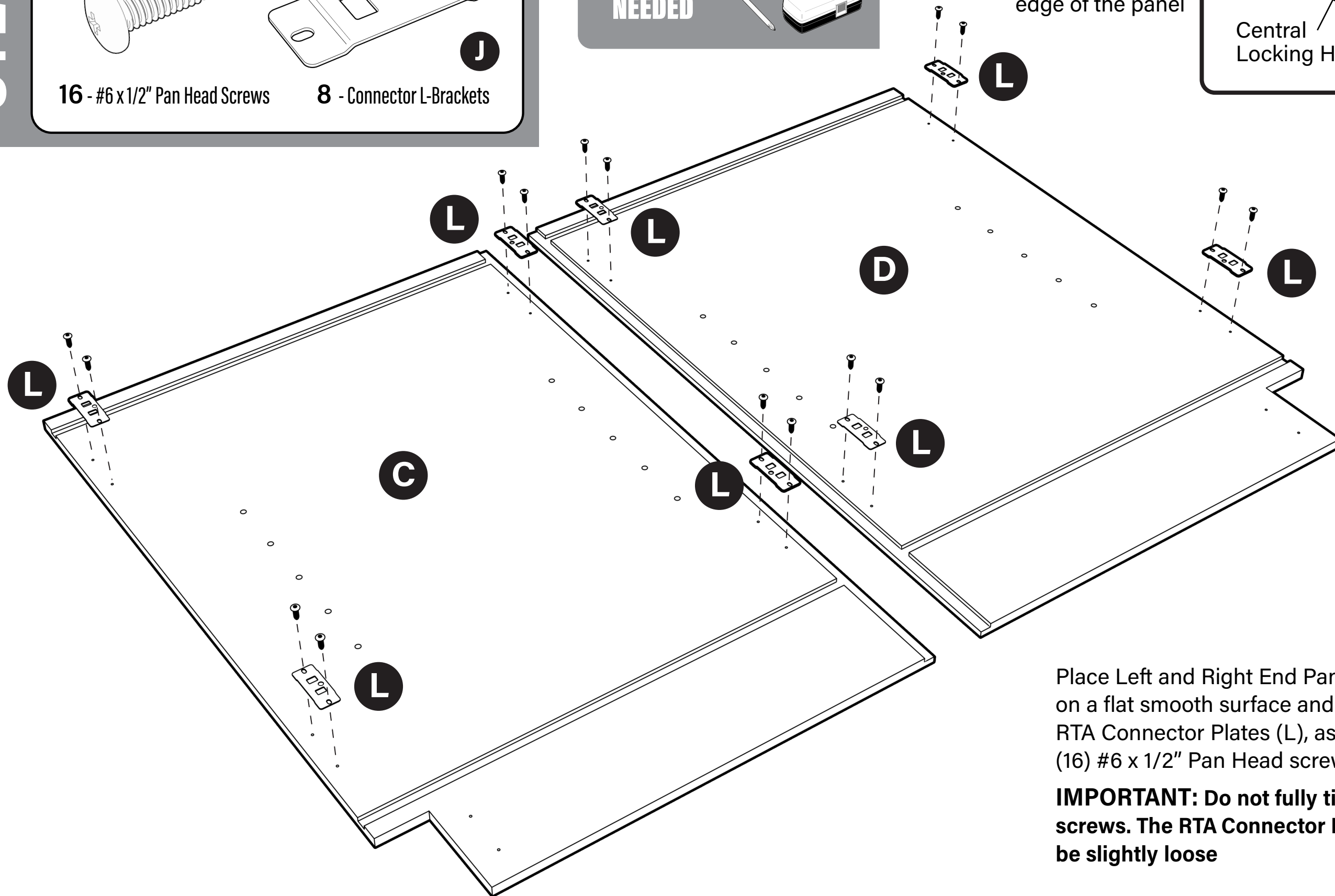

Place Left and Right End Panels (C and D) on a flat smooth surface and install (8) x tan RTA Connector Plates (L), as shown, using (16) #6 x 1/2" Pan Head screws.

**IMPORTANT:** Do not fully tighten the screws. The RTA Connector Plates need to be slightly loose

# STEP 4

## Parts List

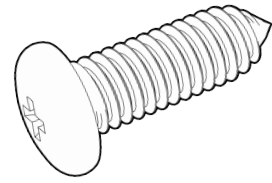

4 - #6 x 1/2" Pan Head Screws

## TOOLS NEEDED

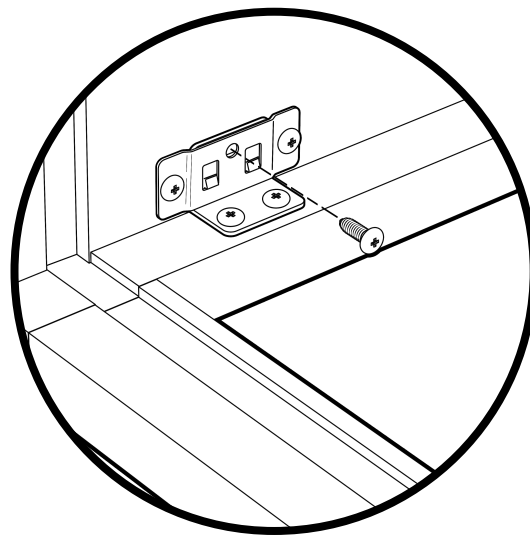
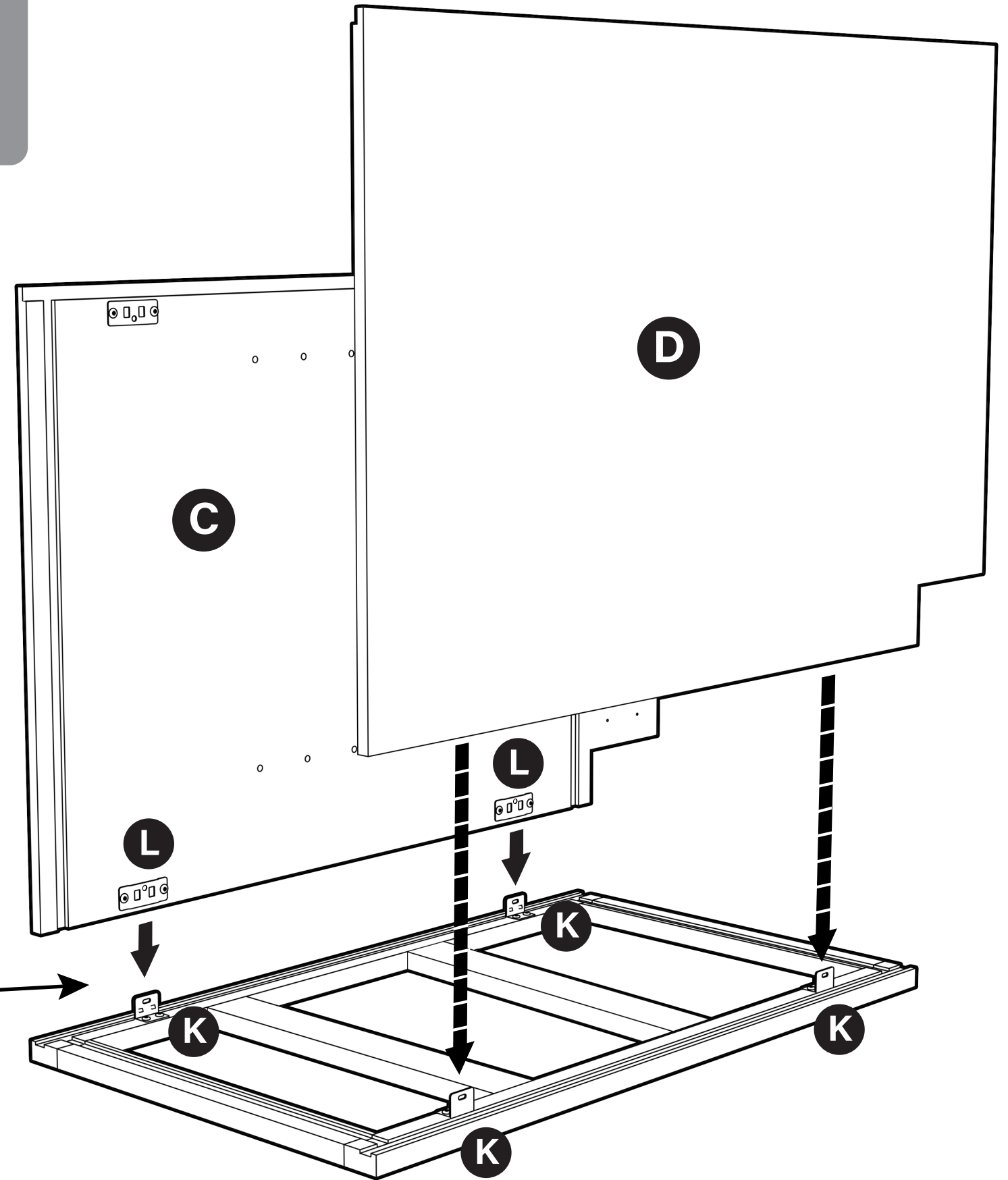
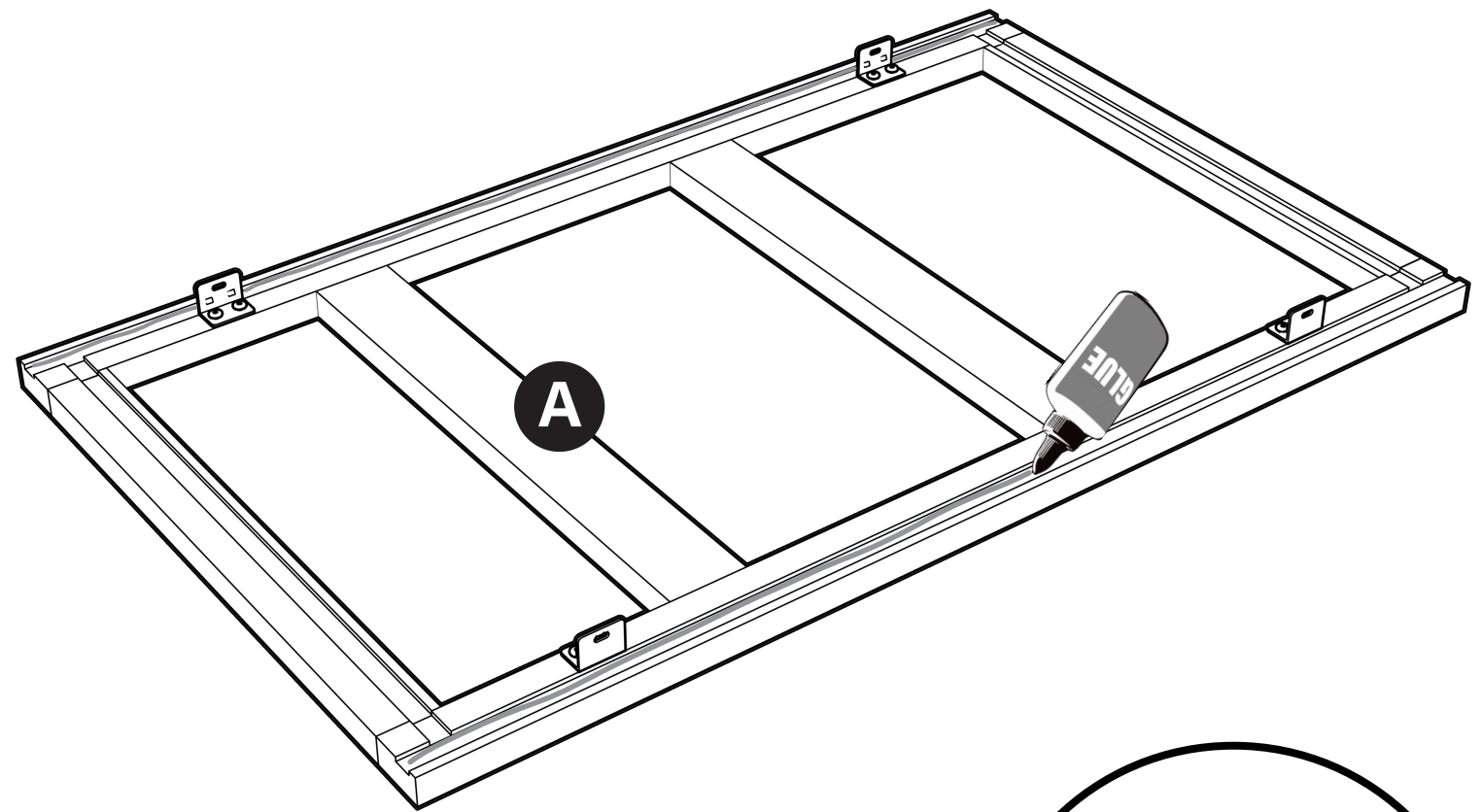

Run a bead of wood glue in the vertical grooves in the Frame (A) and insert End Panels (C and D), so that L-Brackets (K) & Connector Plates (L) snap together. Align the End Panels with the Frame, so that the dado grooves line up. Now, tighten all the Connector Plate screws and secure the Connector Plates and L-Brackets with (4) locking screws: #6 x 1/2" Pan Head.

# STEP 5



TOOLS NEEDED

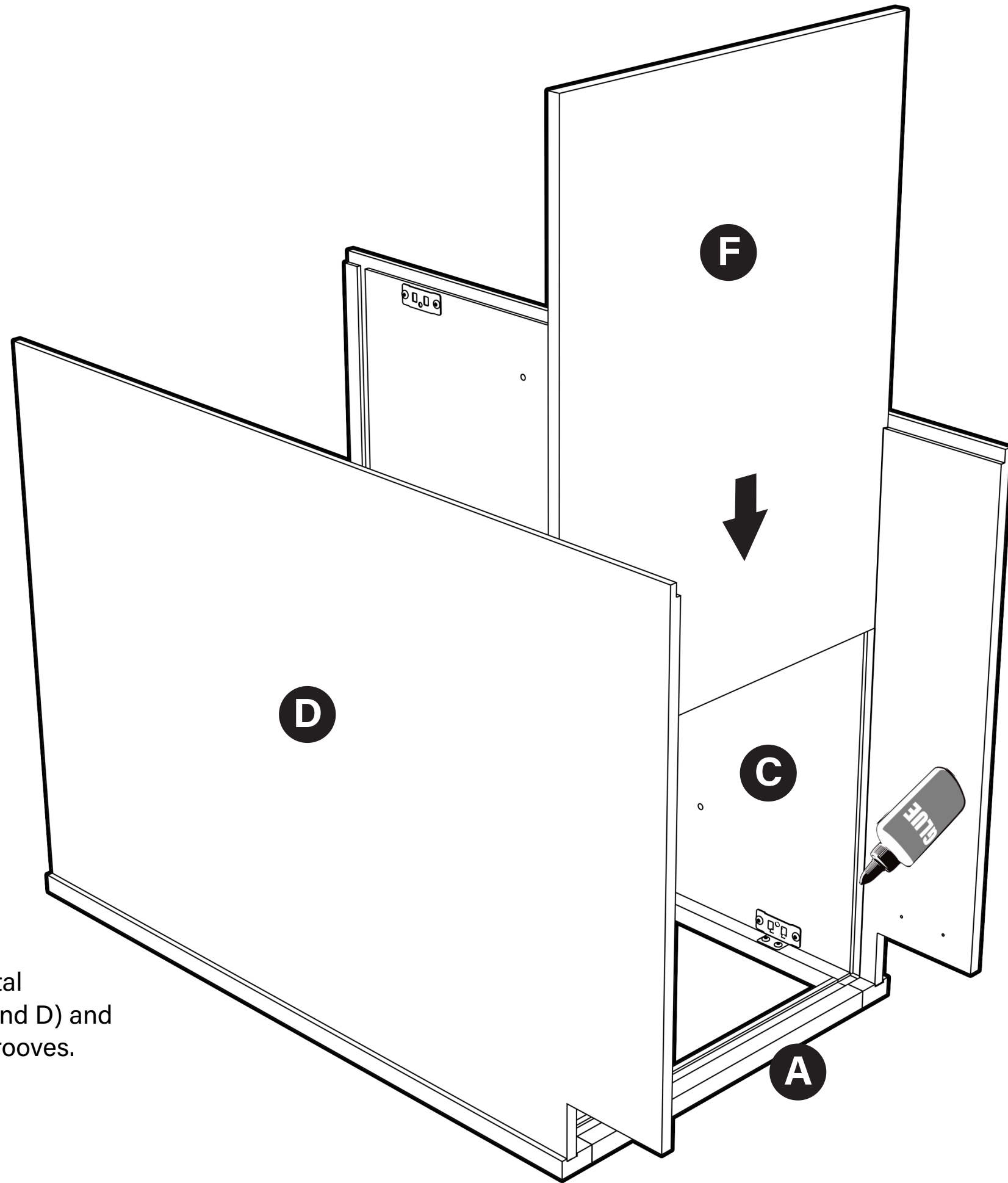

Run a bead of wood glue in the lower horizontal grooves in the Frame (A) and End Panels (C and D) and slide the Fixed Shelf (F) completely into the grooves.

# STEP 6



TOOLS NEEDED

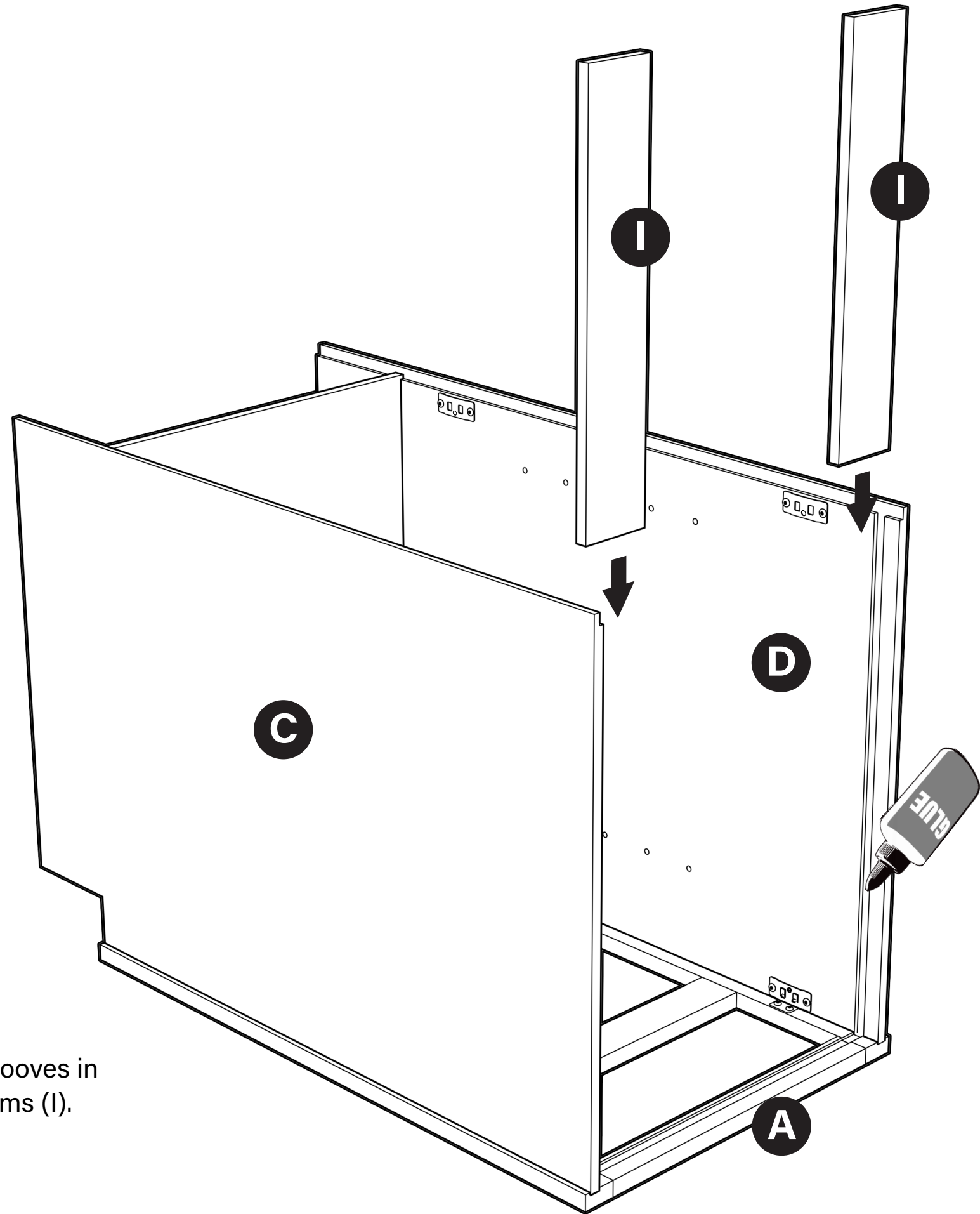

Run a bead of wood glue into upper horizontal grooves in the End Panels (C and D) and insert the (2) I-beams (I).

# STEP 7

## Parts List

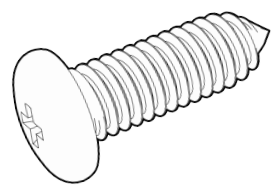

8 - #8 x 1/2" Pan Head Screws

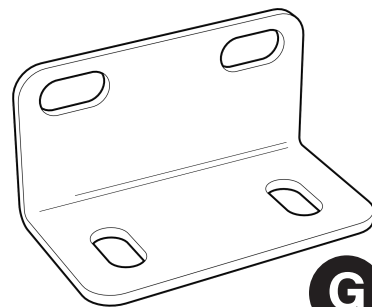

2 - Silver L-Brackets

G

## TOOLS NEEDED

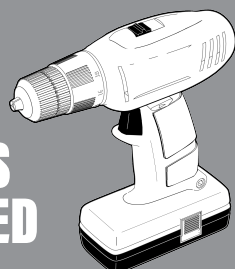

Apply beads of wood glue to the recesses along the back edges of the End Panels (C and D) and in the lower horizontal groove in Back Panel (B). Carefully install Back Panel (B) so that the panels align and the L-Brackets & Connector Plates snap together. Ensure the Fixed Shelf (F) and I-beams (I) are seated fully in grooves in the Back Panel (B) and End Panels (C and D). Secure the I-beams (I) to the back of the Frame (A) with (2) silver L-brackets (G) using (8) #8 x 1/2" Pan Head screws.

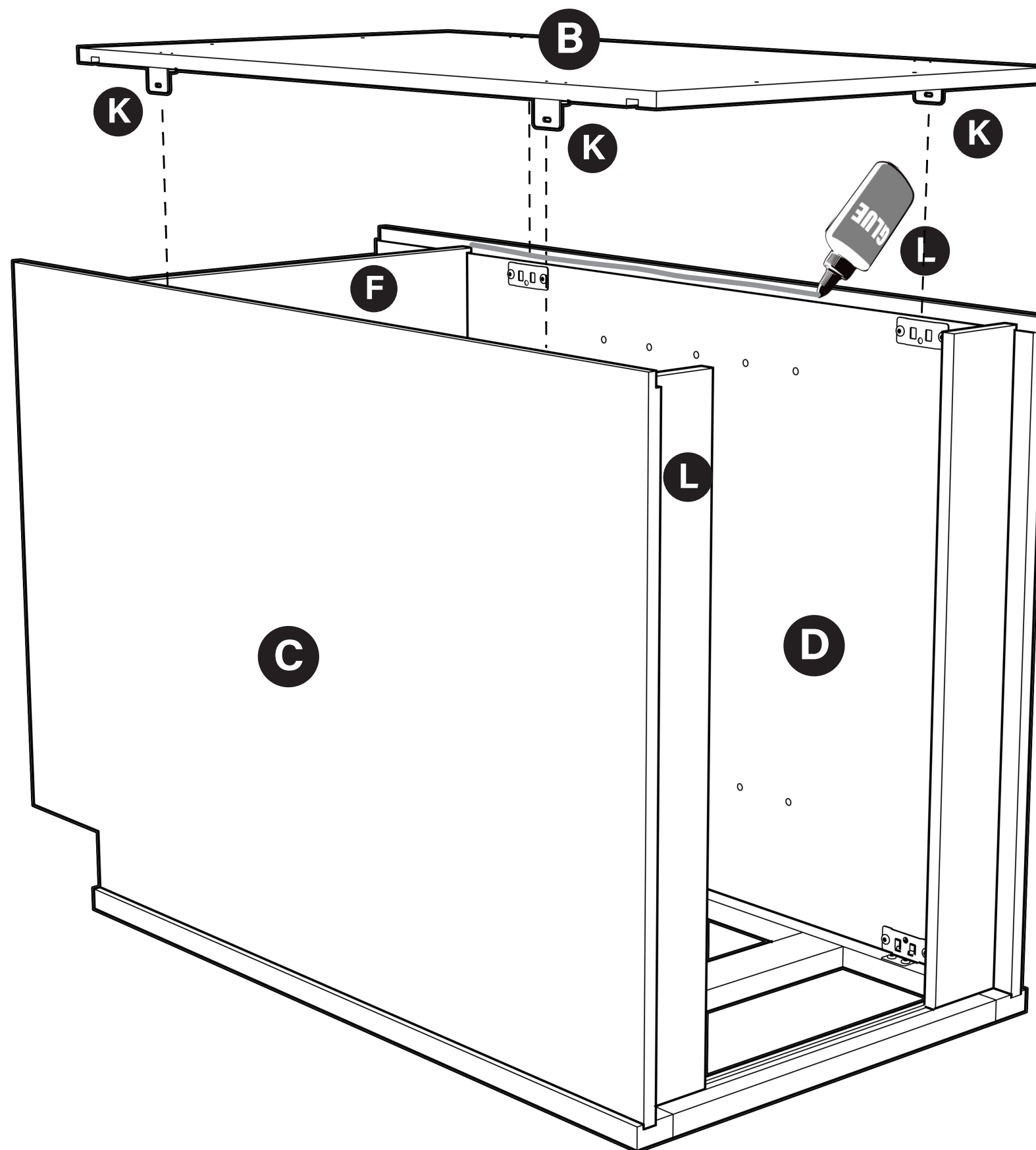
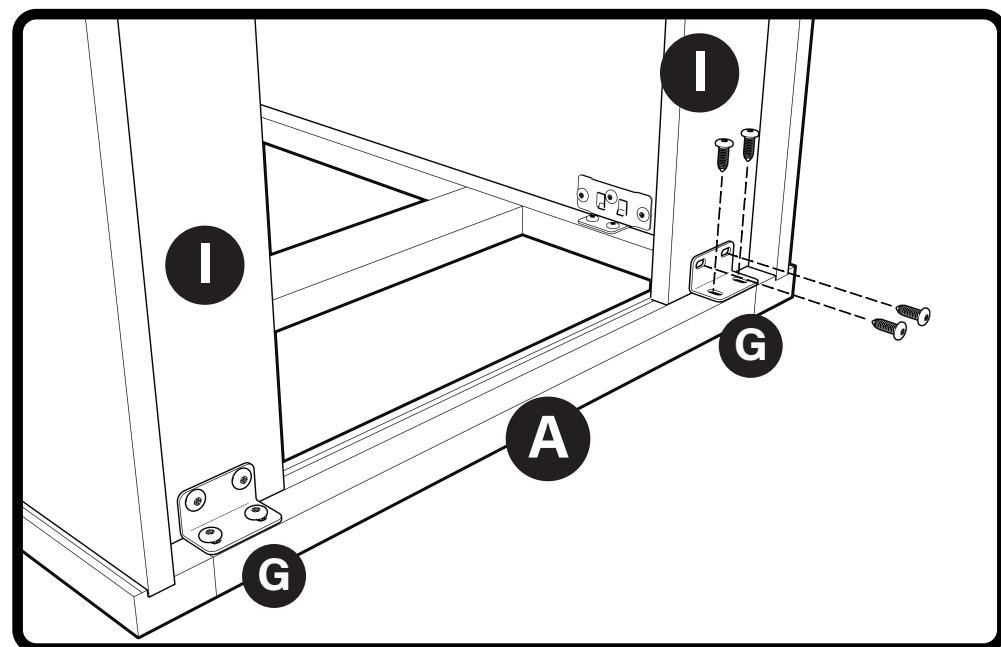

# STEP 8

## Parts List

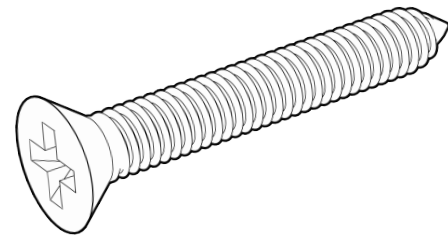

4- #6 x 1" Flat Head Screws

TOOLS  
NEEDED

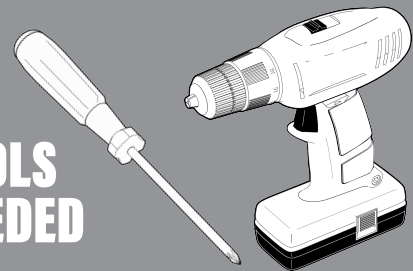

Make sure Back Panel (B) is correctly installed and insert (4) #6 x 1" Countersunk Flat Head screws thru the predrilled holes. Tighten the screws securely into the Fixed Shelf (F) and I-beams (I)."

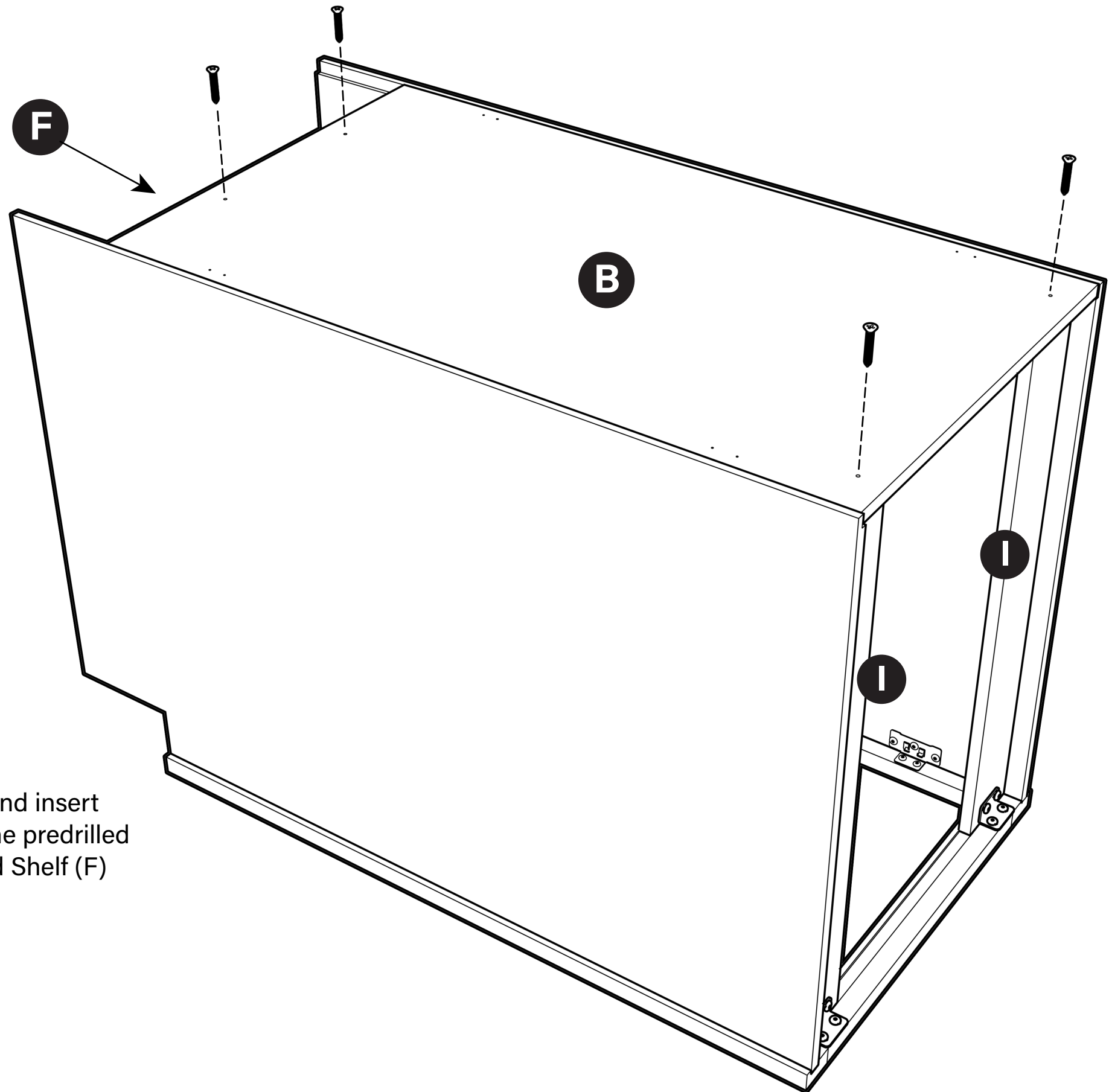

# STEP 9

## Parts List

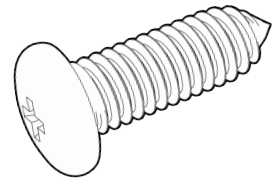

4 - #6 x 1/2" Pan Head Screws

## TOOLS NEEDED

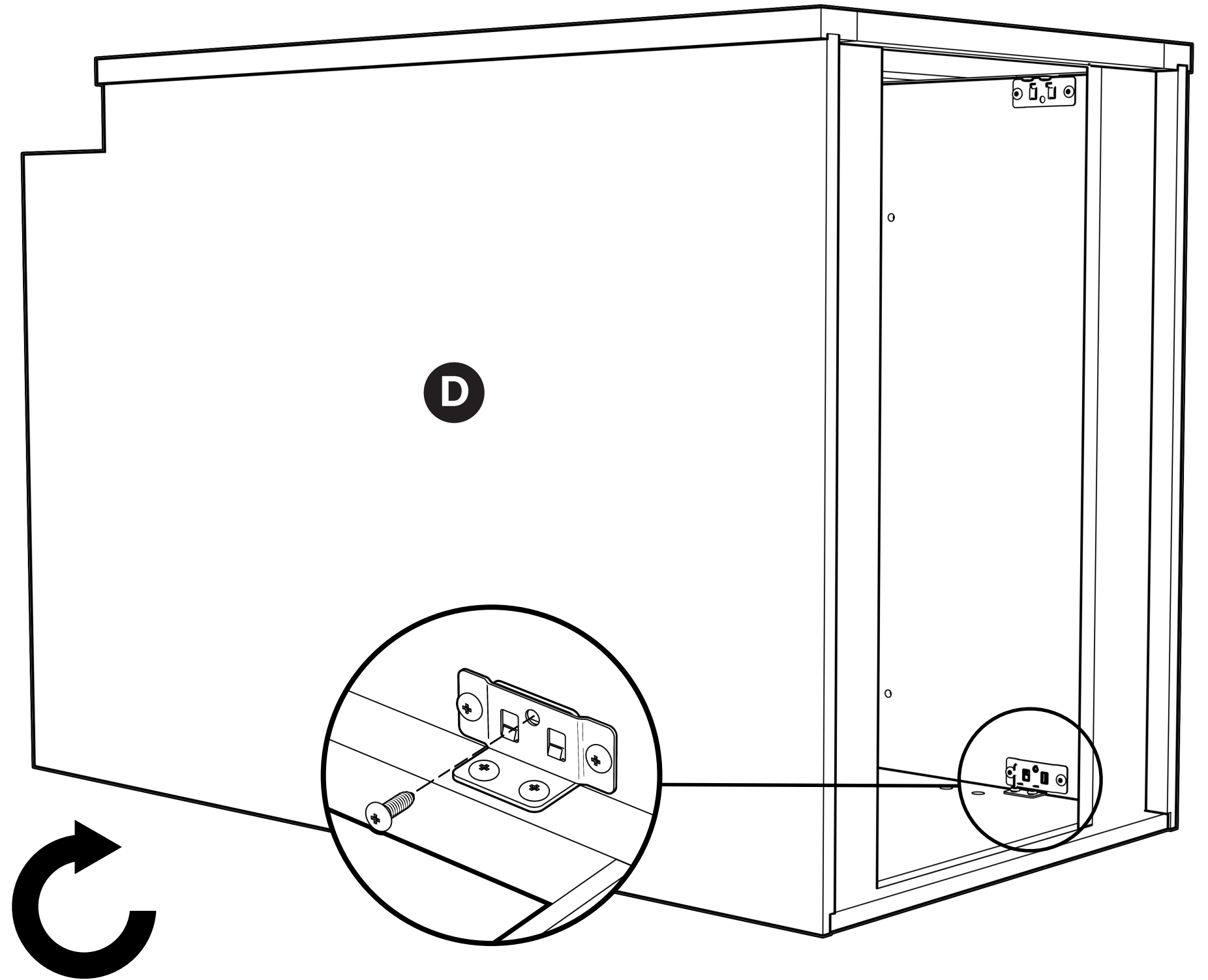
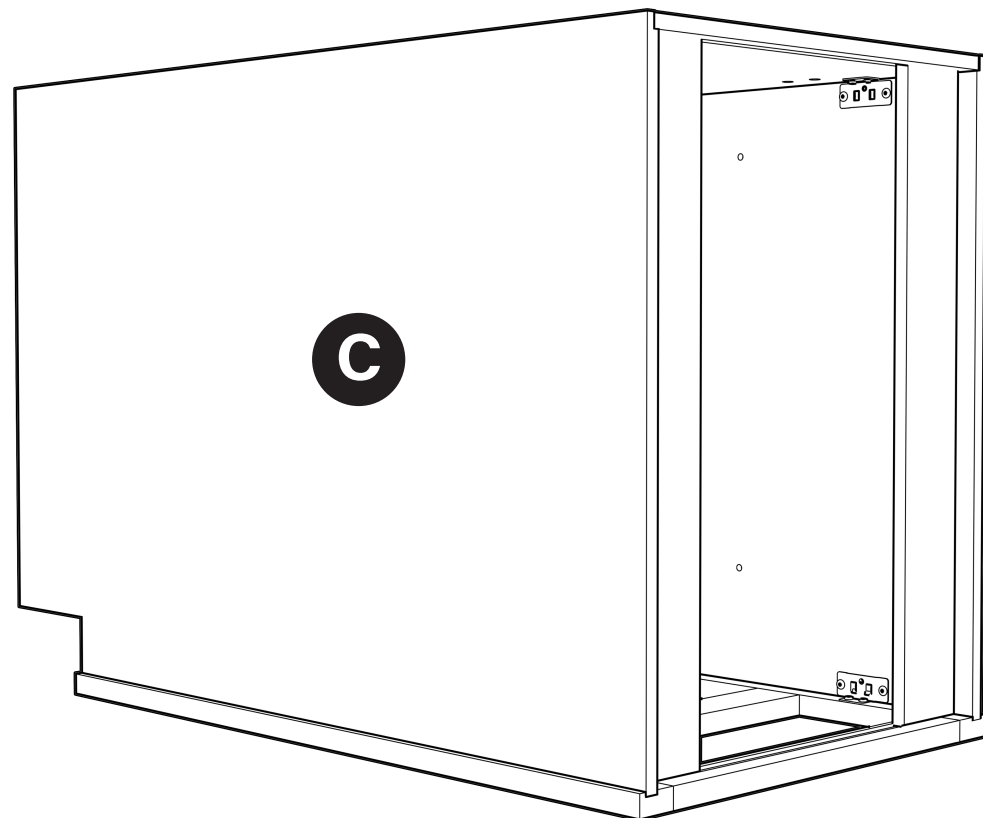
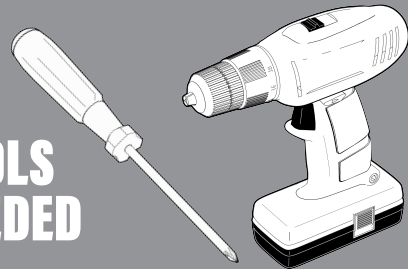

Carefully turn the cabinet over, make sure it is square, tighten all the Connector Plate screws and then secure the Connector Plates and L-Brackets with (4) locking screws: (4) #6 x 1/2" Pan Head screws.

# STEP 10

## Parts List

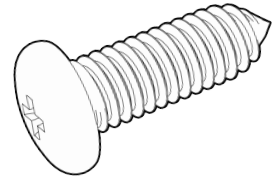

4- #8 x 1/2" Pan Head Screws

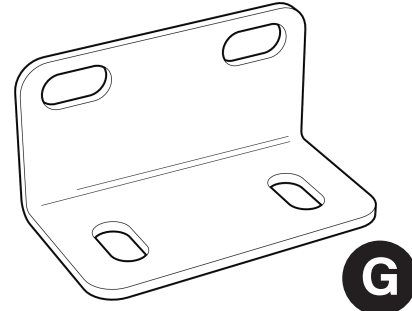

2 - Silver L-Brackets

## TOOLS NEEDED

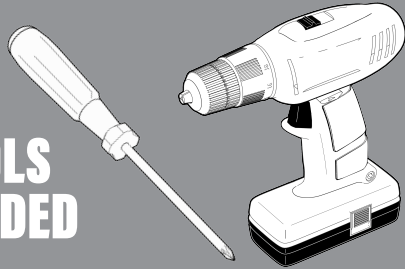

At the Toe Kick cutout, attach (2) silver L-brackets (G) to the End Panels (C and D) with (4) #8 x 1/2" Pan Head screws

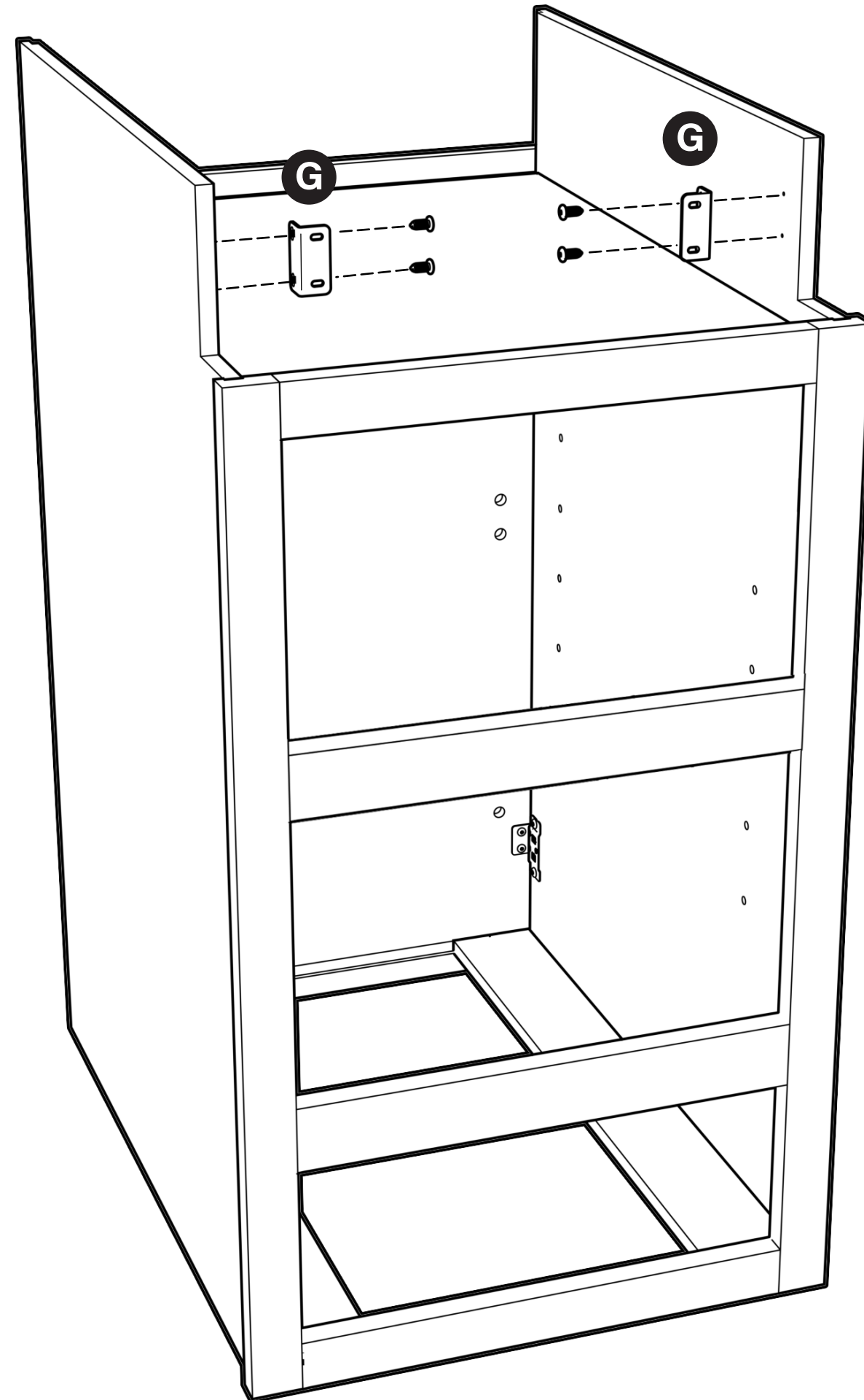

# STEP 11

## Parts List

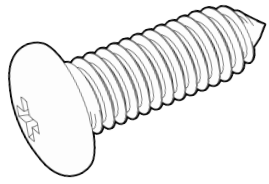

4 - #8 x 1/2" Pan Head Screws

## TOOLS NEEDED

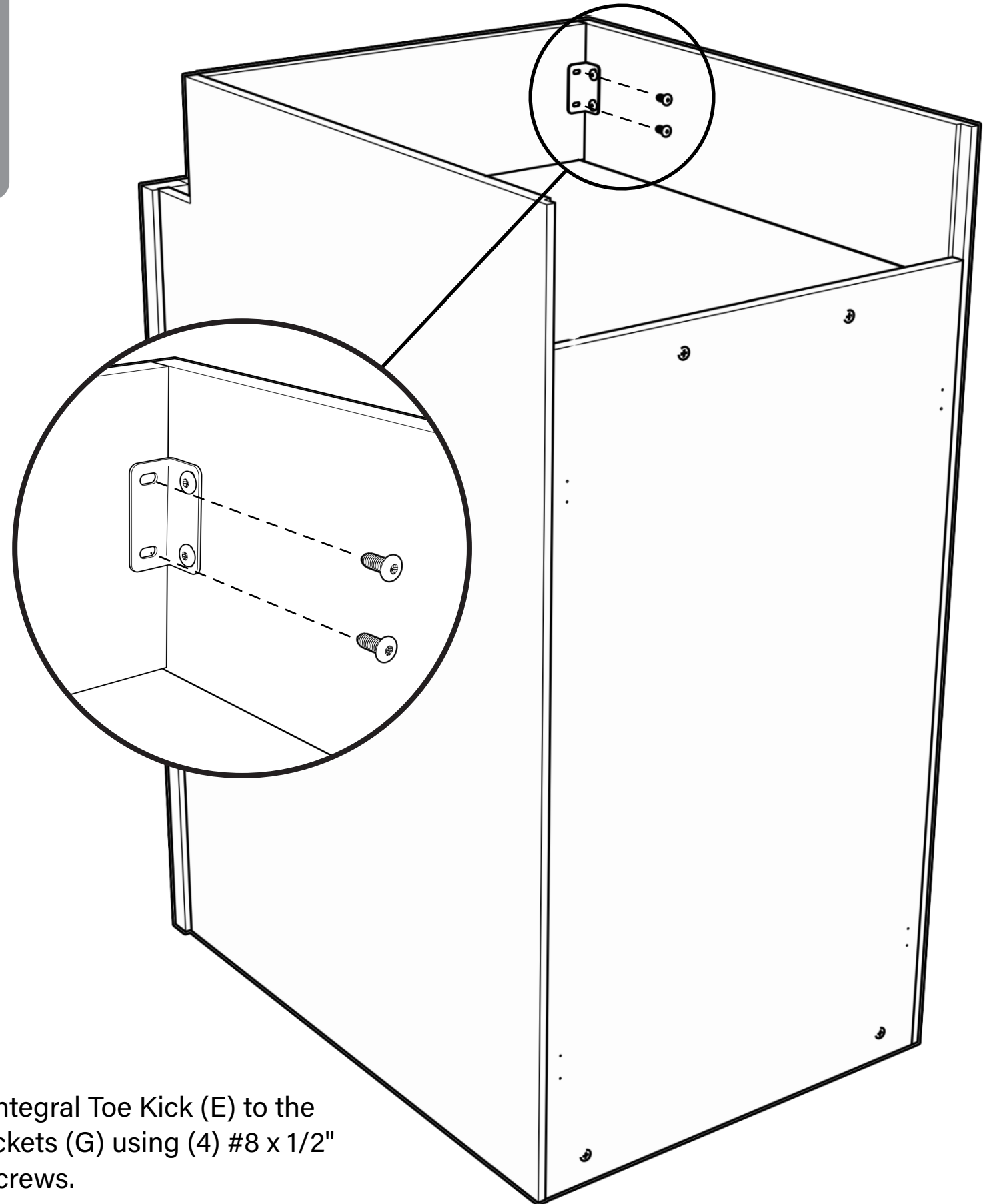
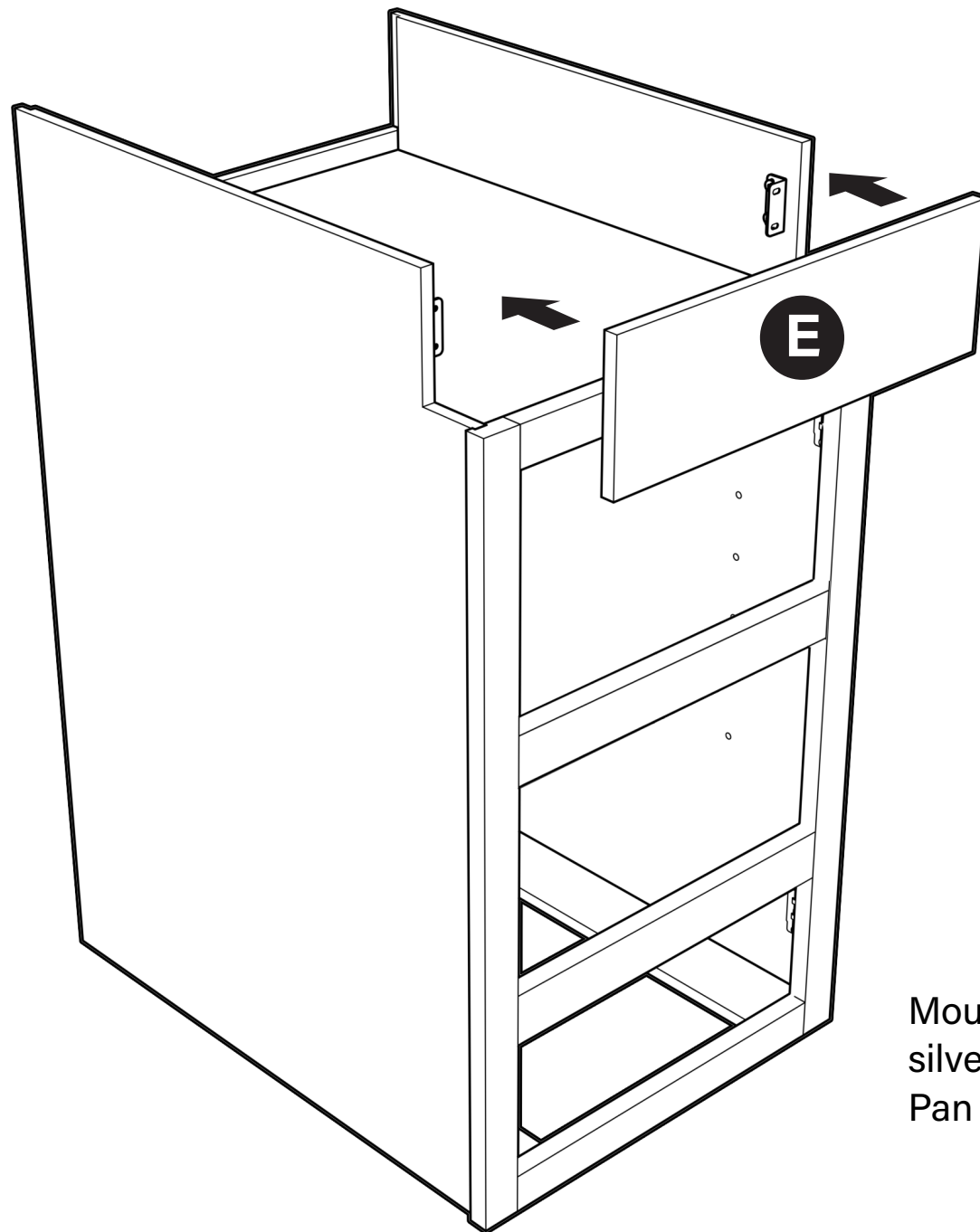
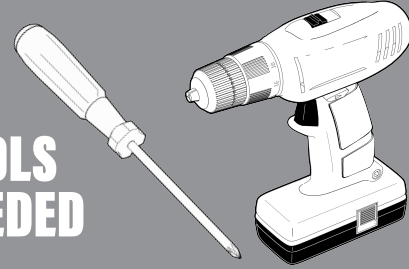

Mount the integral Toe Kick (E) to the silver L-brackets (G) using (4) #8 x 1/2" Pan Head screws.

# STEP 12

## Parts List

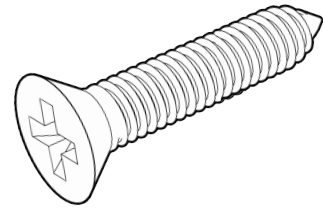

12- #6 x 5/8" Flat Head screws

## TOOLS NEEDED

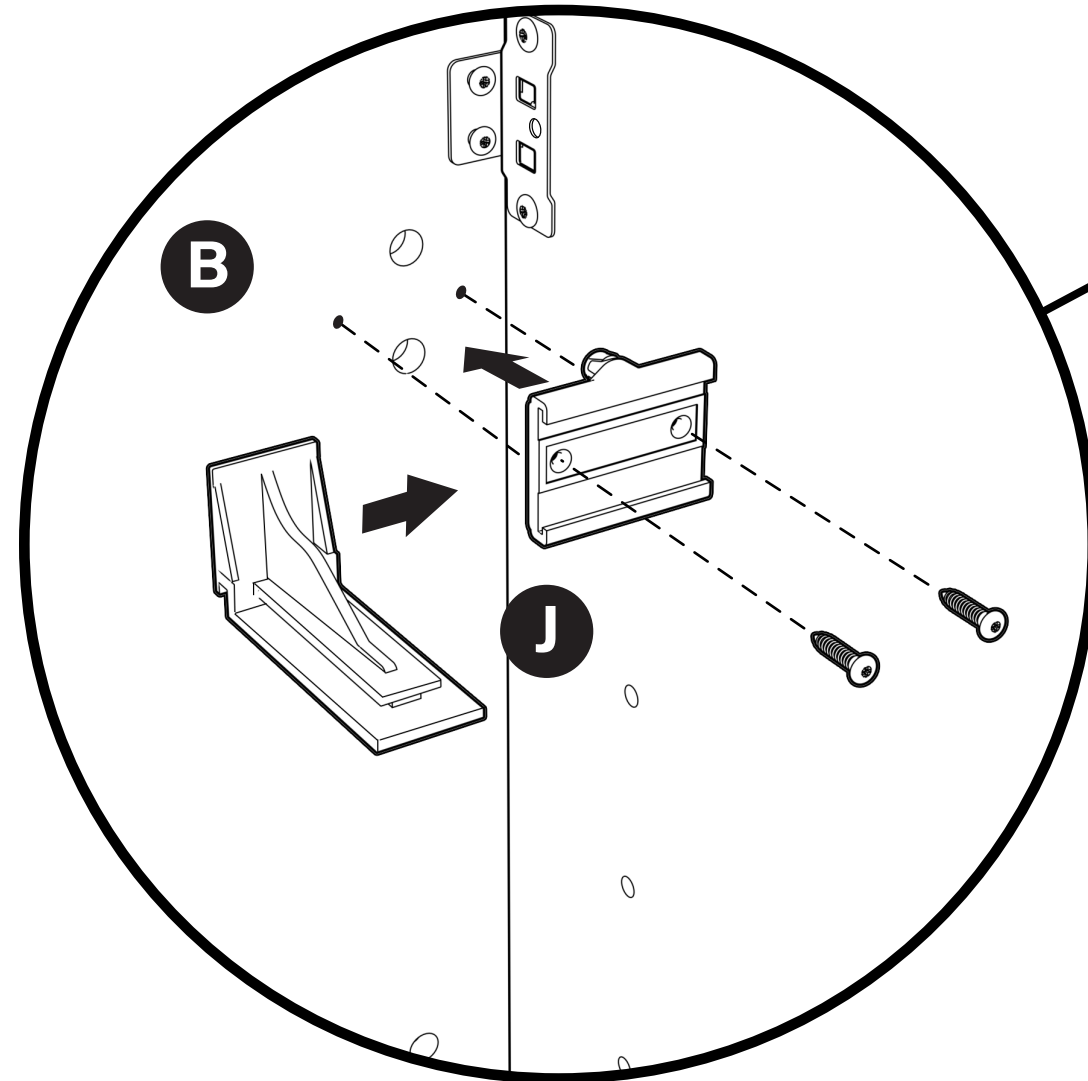
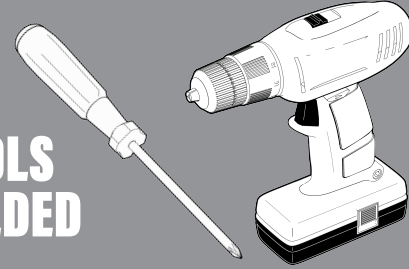

Stand cabinet upright and insert (6) Runner Rear Brackets (J) into Back Panel (B) and secure with (12) #6 x 5/8" Countersunk Flat Head screws.

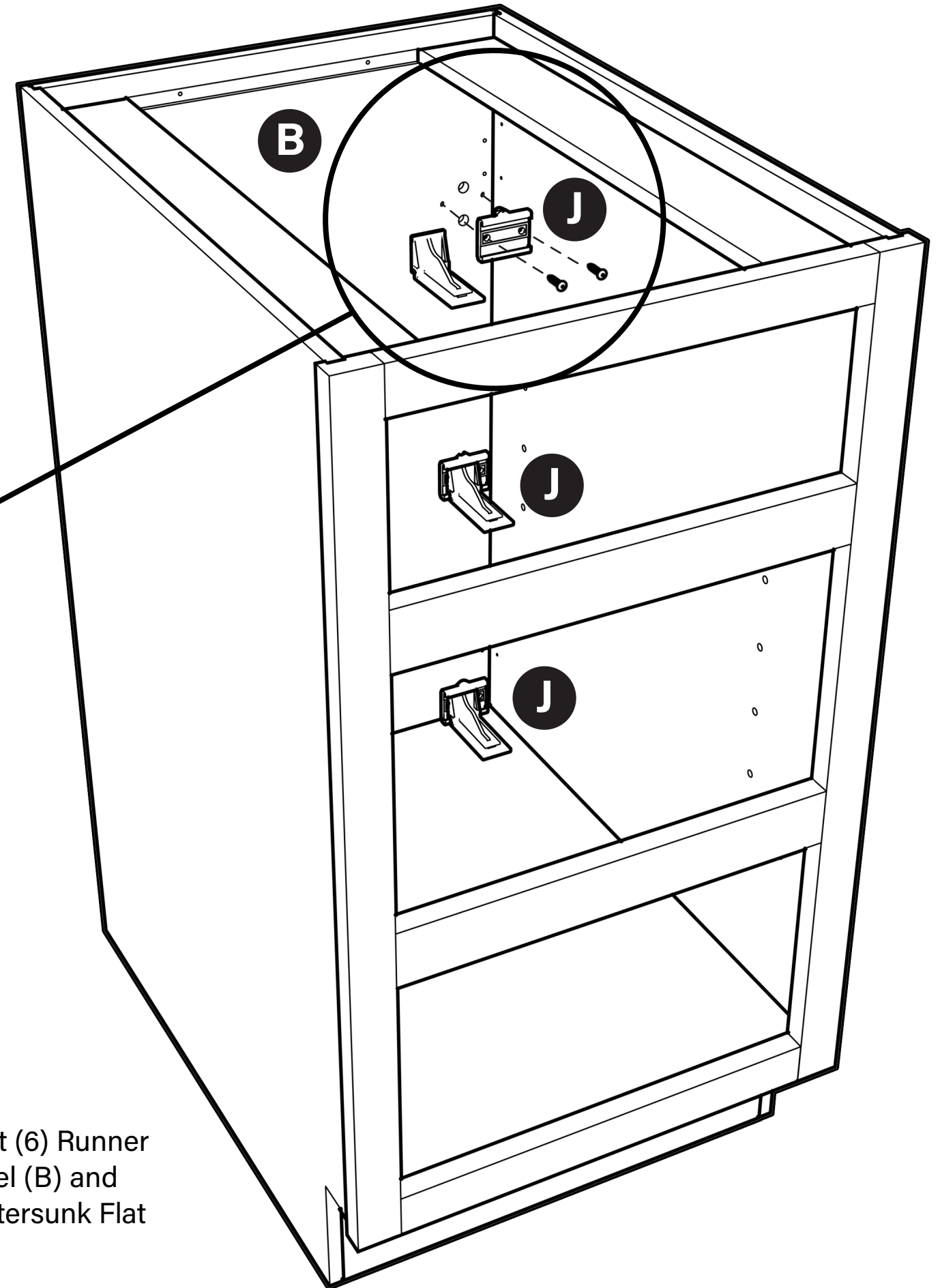

# STEP 13

## Parts List

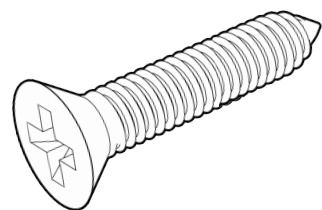

6- #6 x 5/8" Flat Head screws

## TOOLS NEEDED

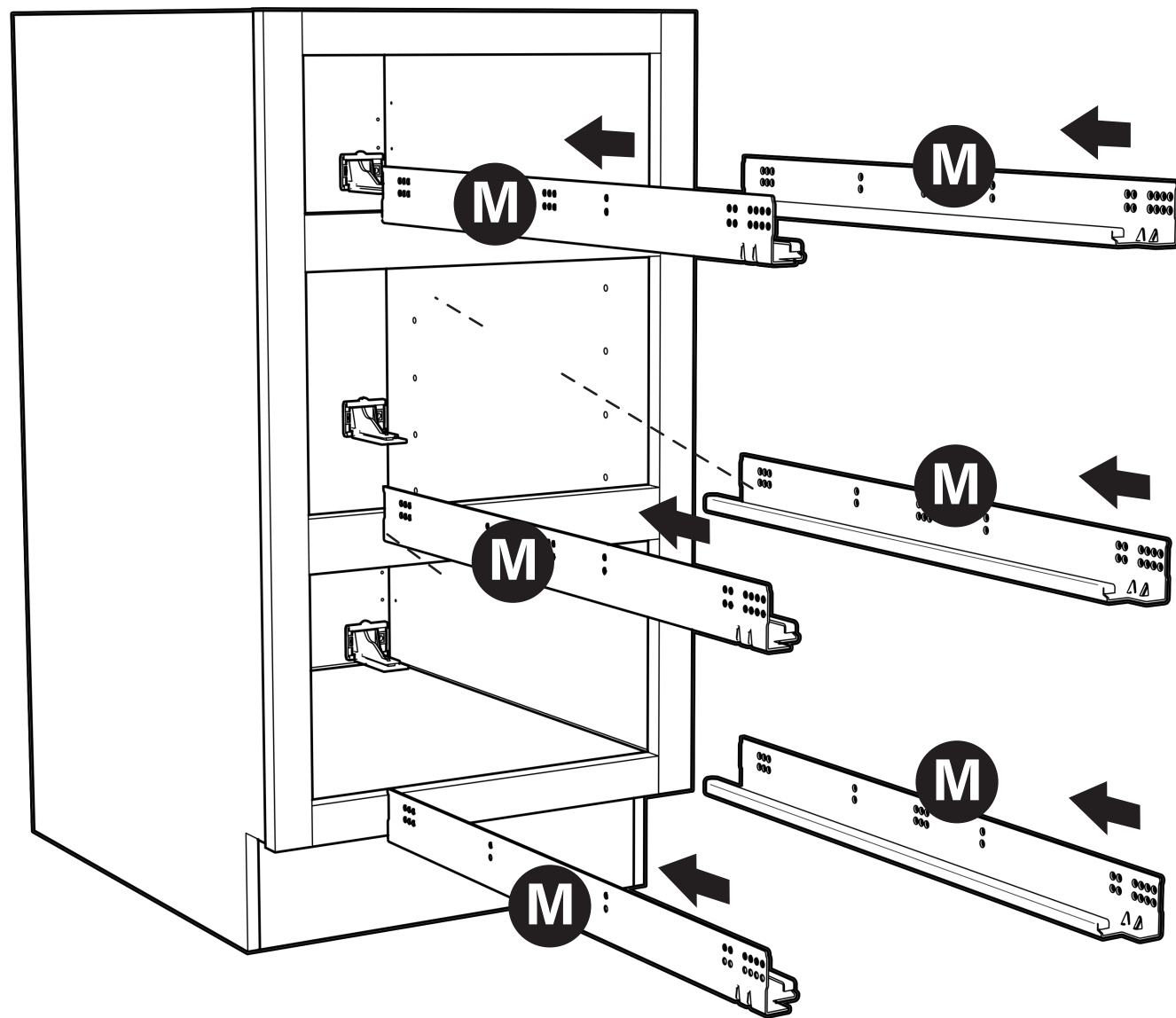
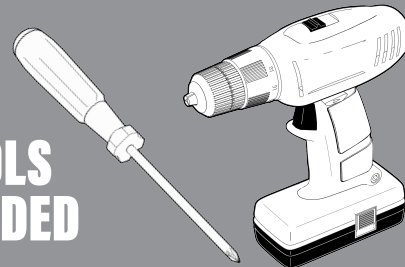

Slide Drawer Runners (M) into Runner Brackets (J) and rest the front of the runners on the Frame (A). Secure the runners to the side frame with (2) #6 x 5/8" Countersunk Pan Head screws.

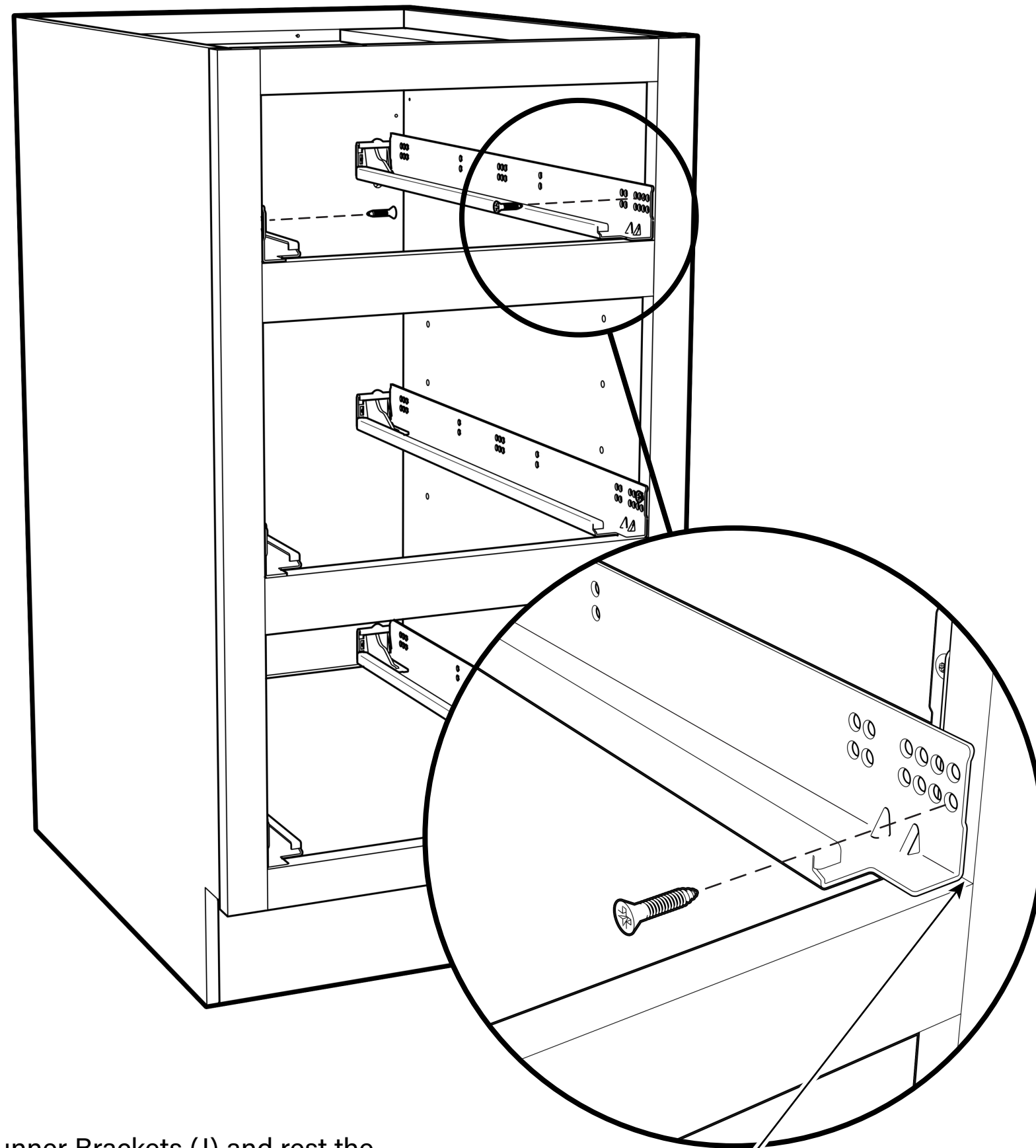

Runner should be set back slightly, so the screw is located in the center of the frame

# STEP 14



TOOLS NEEDED

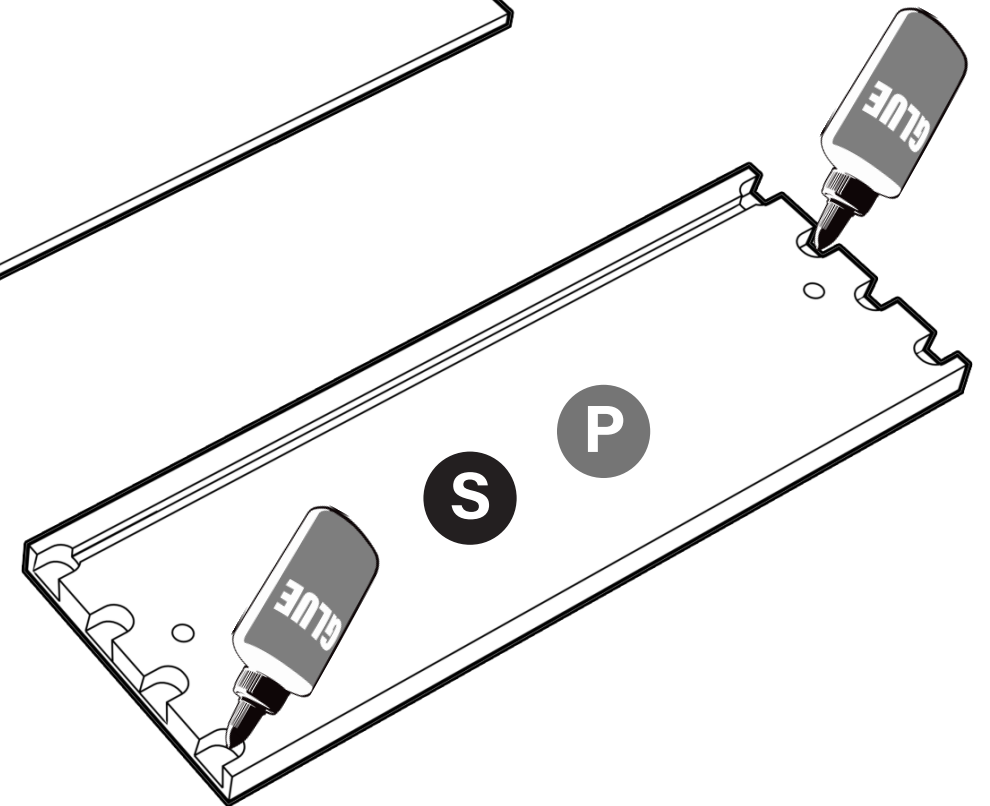
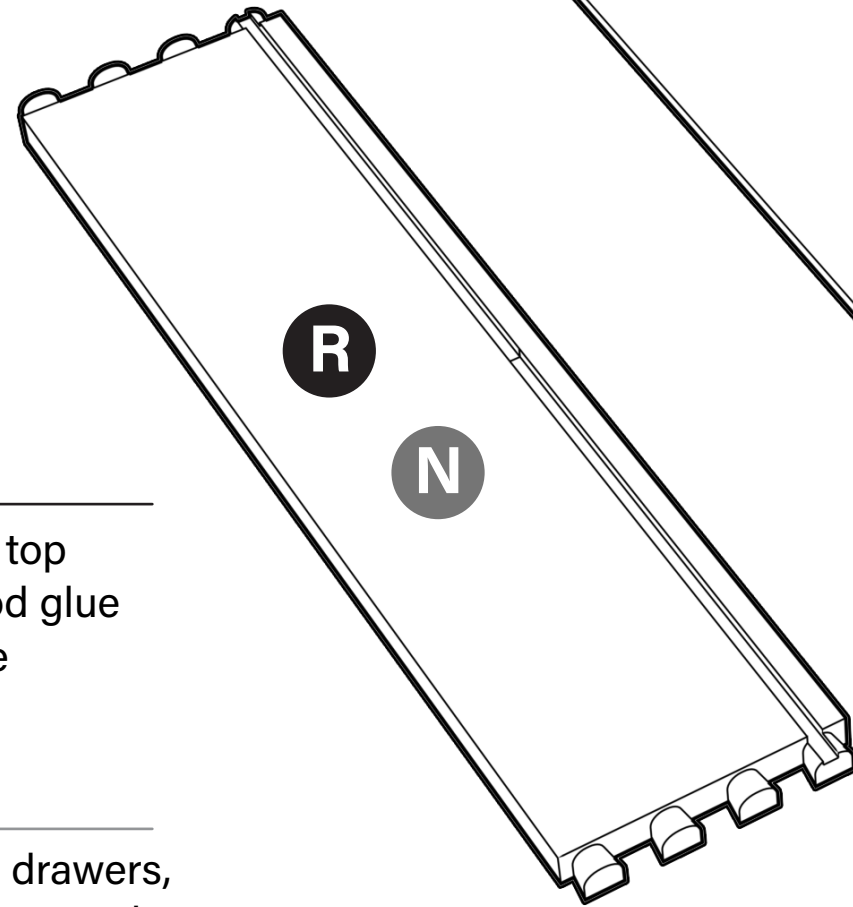
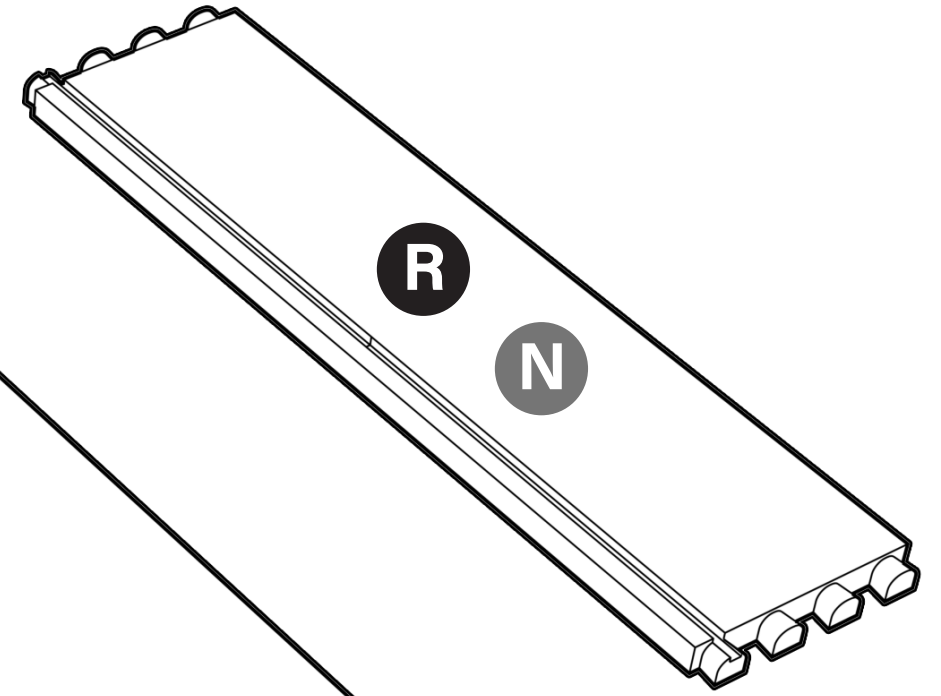
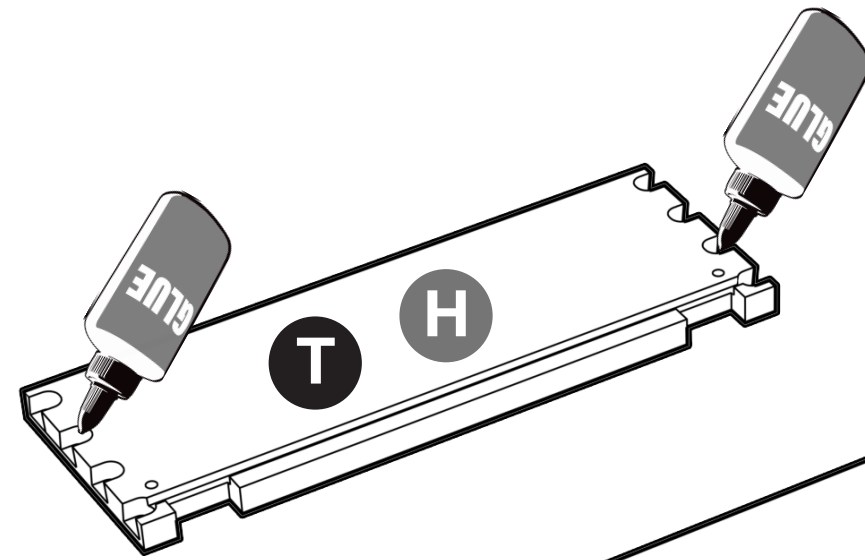

## **SMALLER DRAWER**

Before assembling the smaller top drawer, put a dab of white wood glue into each dovetail recess in the Front (S) and Back (T) panels

## **LARGER DRAWERS**

Before assembling the 2 larger drawers, put a dab of white wood glue into each dovetail recess in the Front (H) and Back (P) panels

# STEP 15

## SMALLER DRAWER

Lay (1) Drawer Side (R) on a smooth flat surface and insert the Front (S) and Back (T) panels, ensuring that the bottom grooves line up.

## LARGER DRAWERS

Lay (1) Drawer Side (N) on a smooth flat surface and insert the Front (P) and Back (H) panels, ensuring that the bottom grooves line up. REPEAT

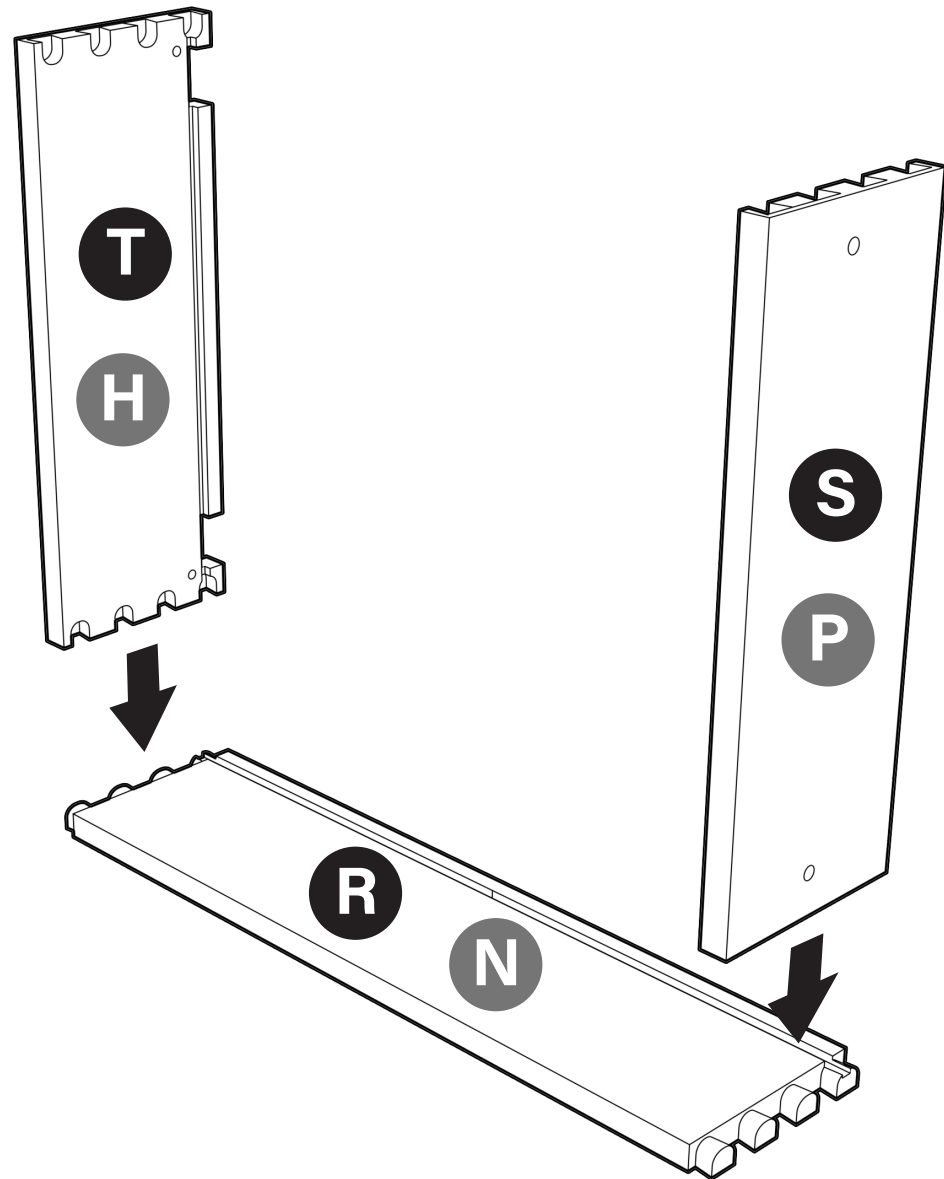

# STEP 16

TOOLS  
NEEDED

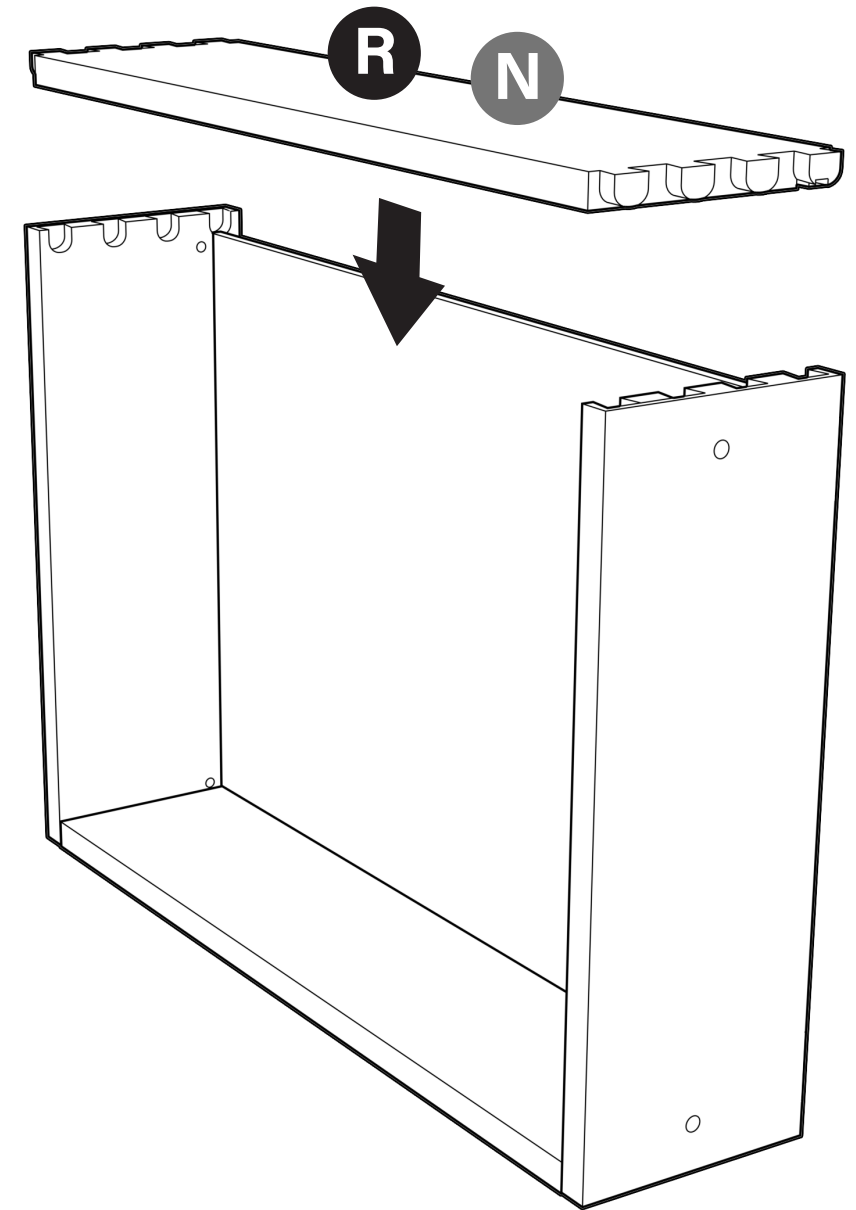
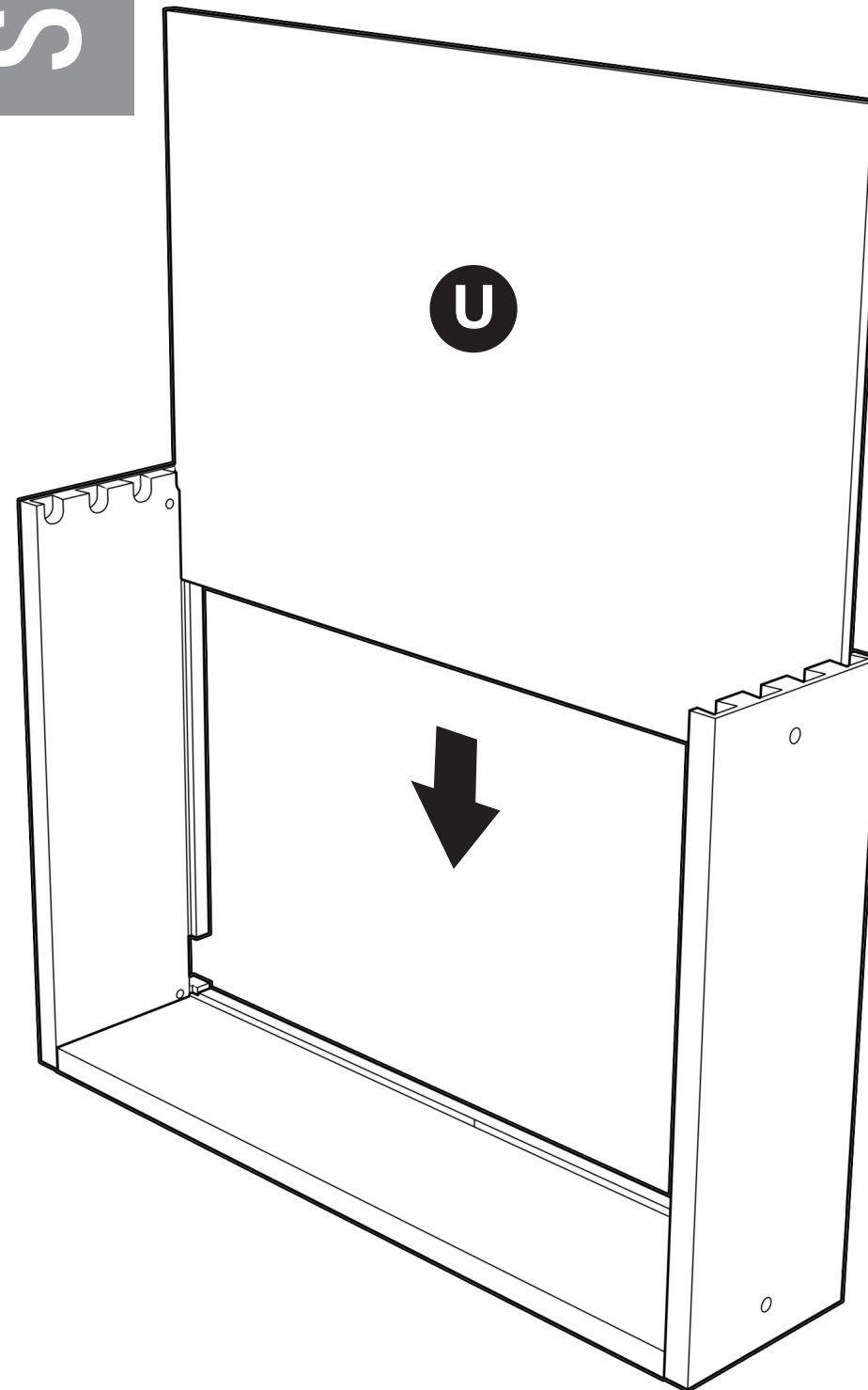
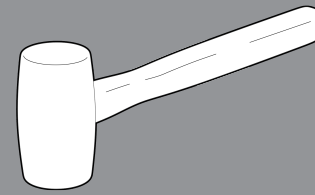

Slide the Drawer Bottom (U) into the grooves and install the other Drawer Side. If necessary, use a rubber mallet to gently tap the joints into place.

# STEP 17

## Parts List

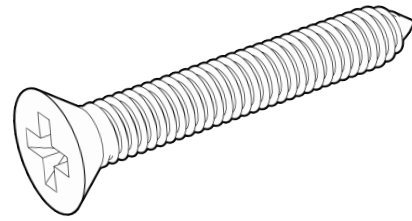

12- #6 x 1" Flat Head screws

## TOOLS NEEDED

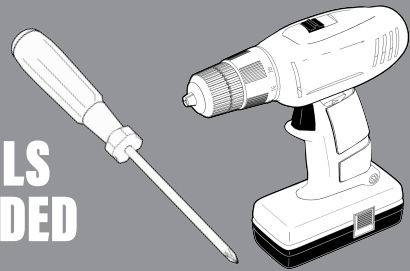

To secure the drawer boxes, while the glue sets up, add (12) #6 x 1" Countersunk Flat Head screws in predrilled holes in Front and Back of all drawers.

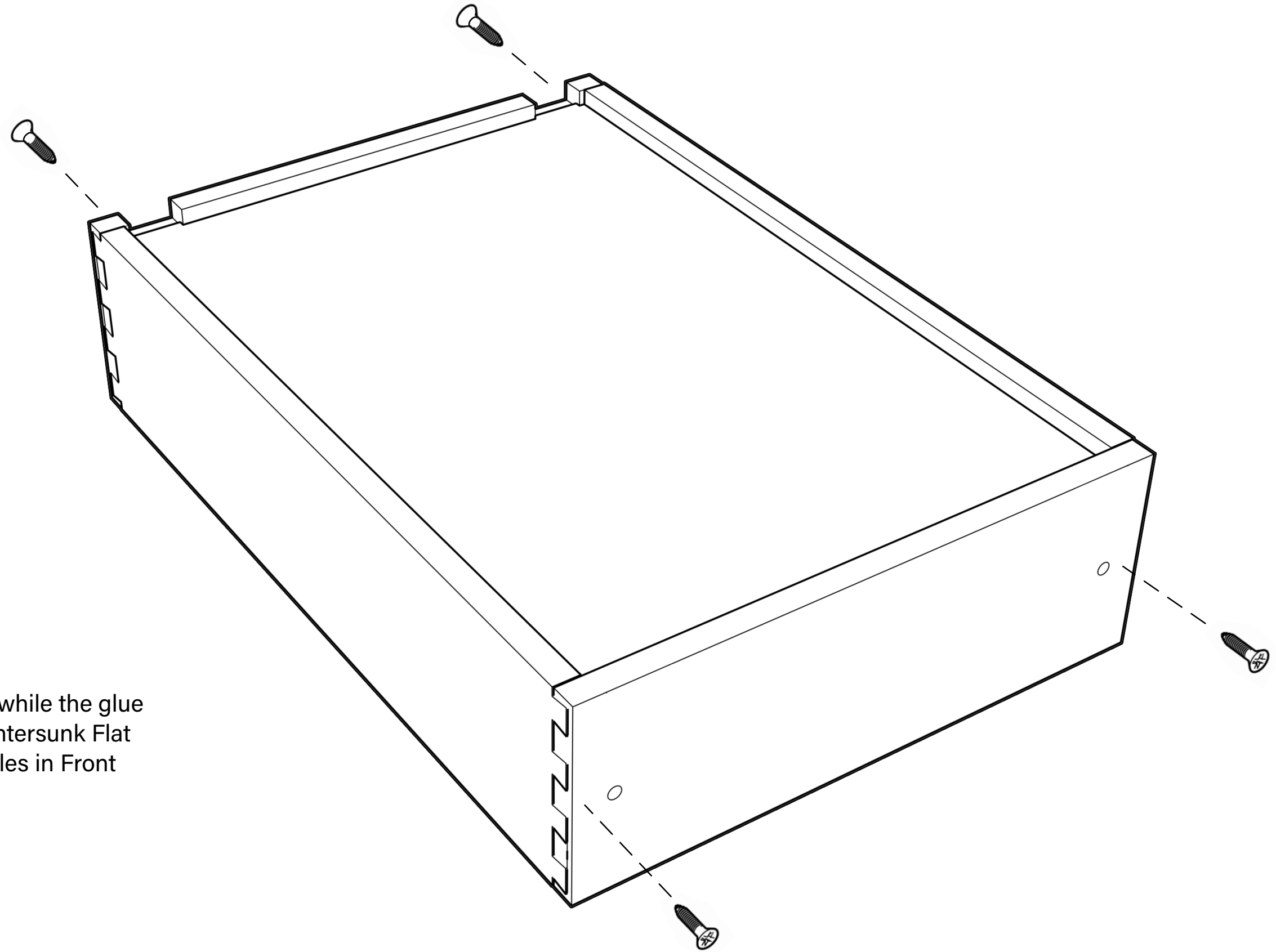

# STEP 18

## Parts List

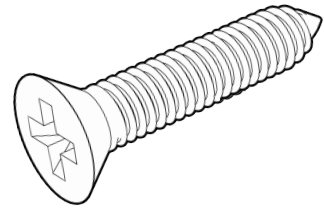

12- #6 x 5/8" Flat Head screws

## TOOLS NEEDED

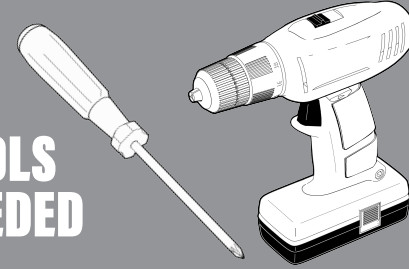

W

V

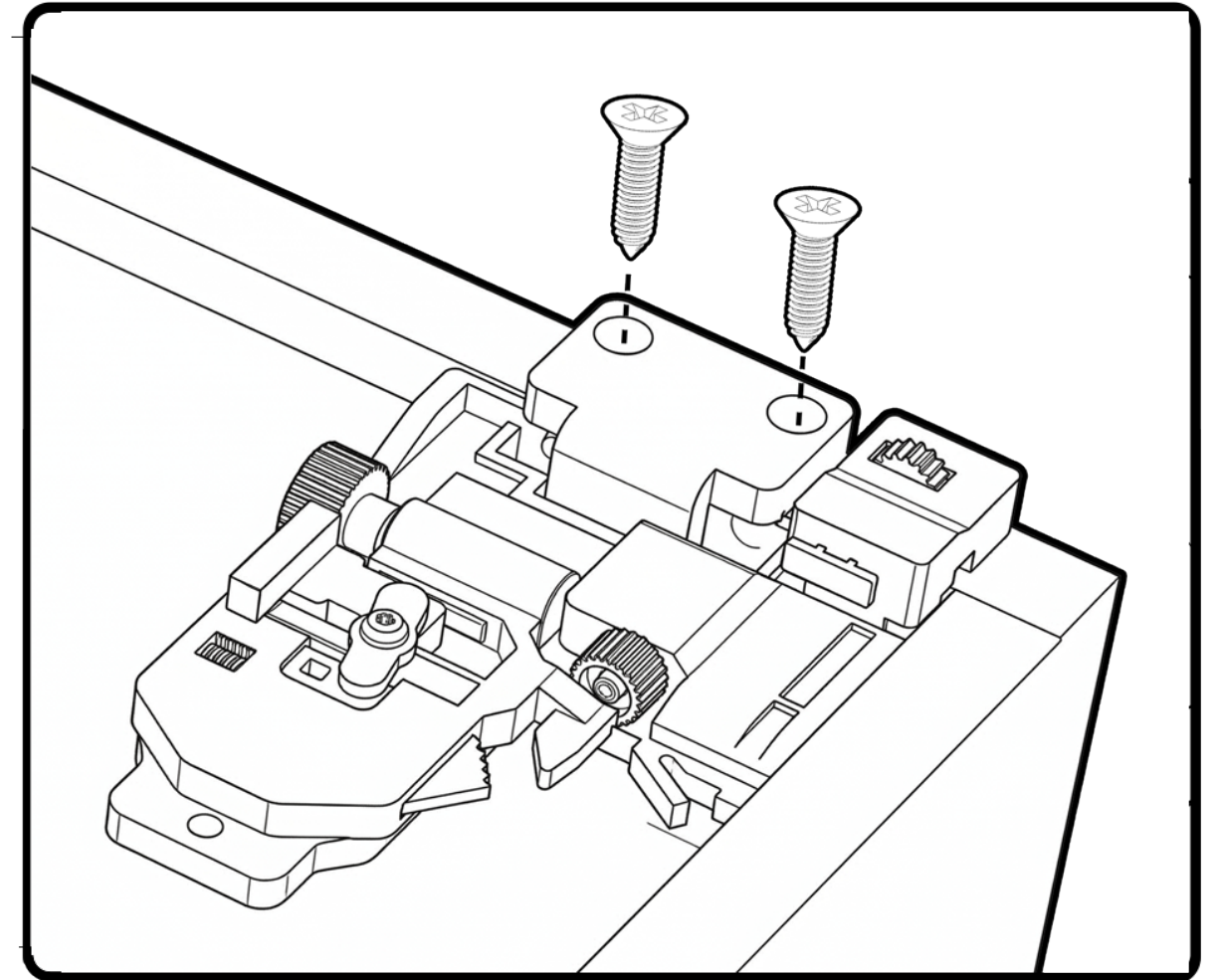
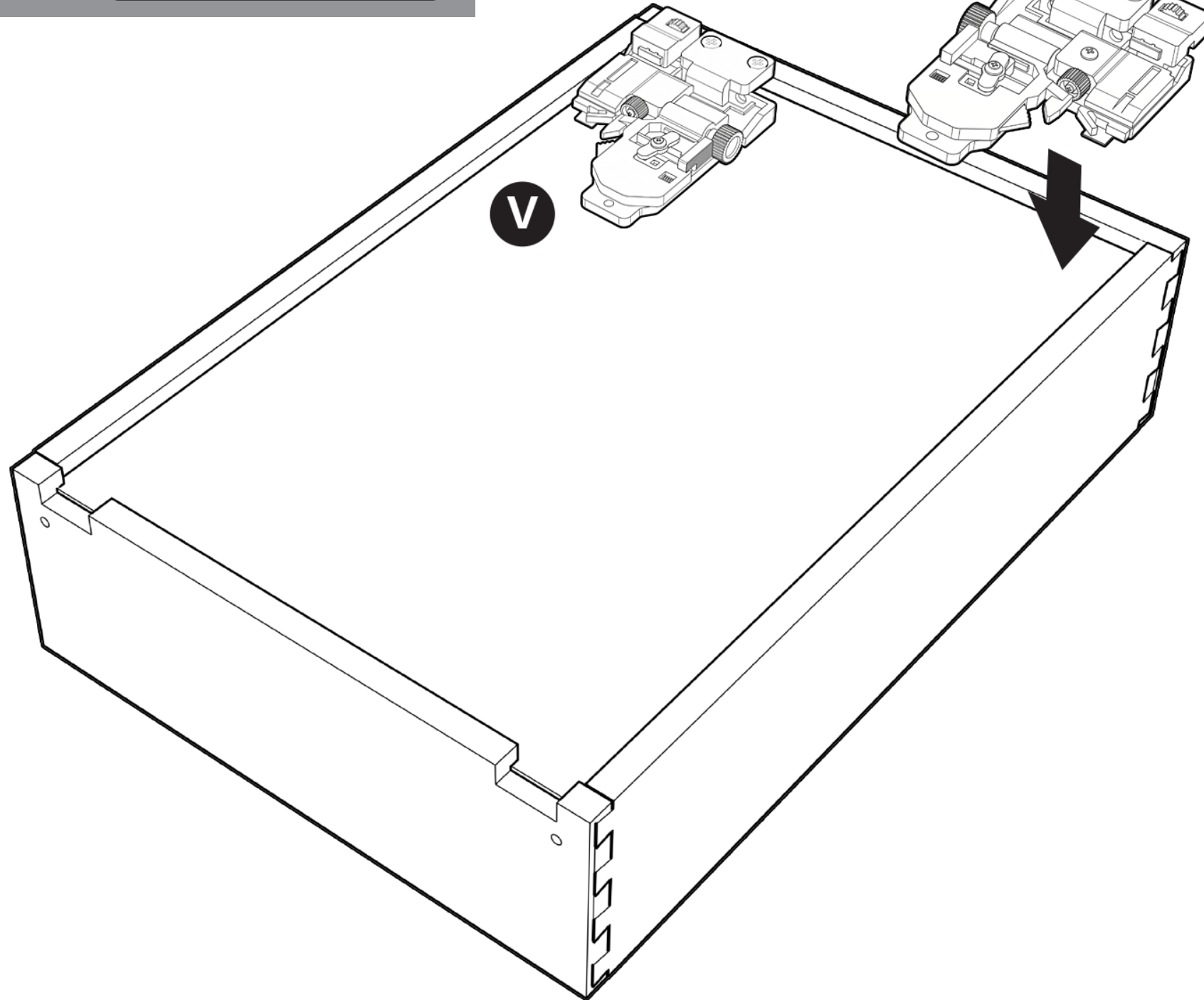

Turn drawers over and install (2) Locking Devices (V and W), to each drawer as shown, using (12) #6 x 5/8" Flat Head screws. Do not overtighten the screws

# STEP 19

## Parts List

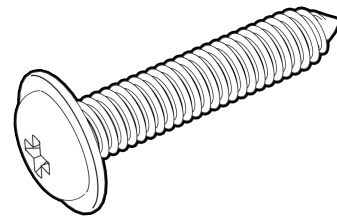

6- #8 x 1-1/2" Large Washer Head

## TOOLS NEEDED

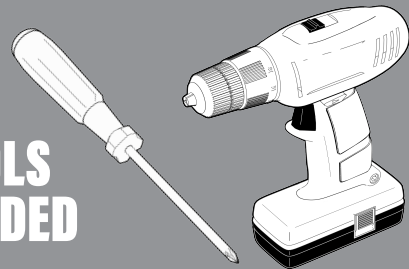

Clear Bumper

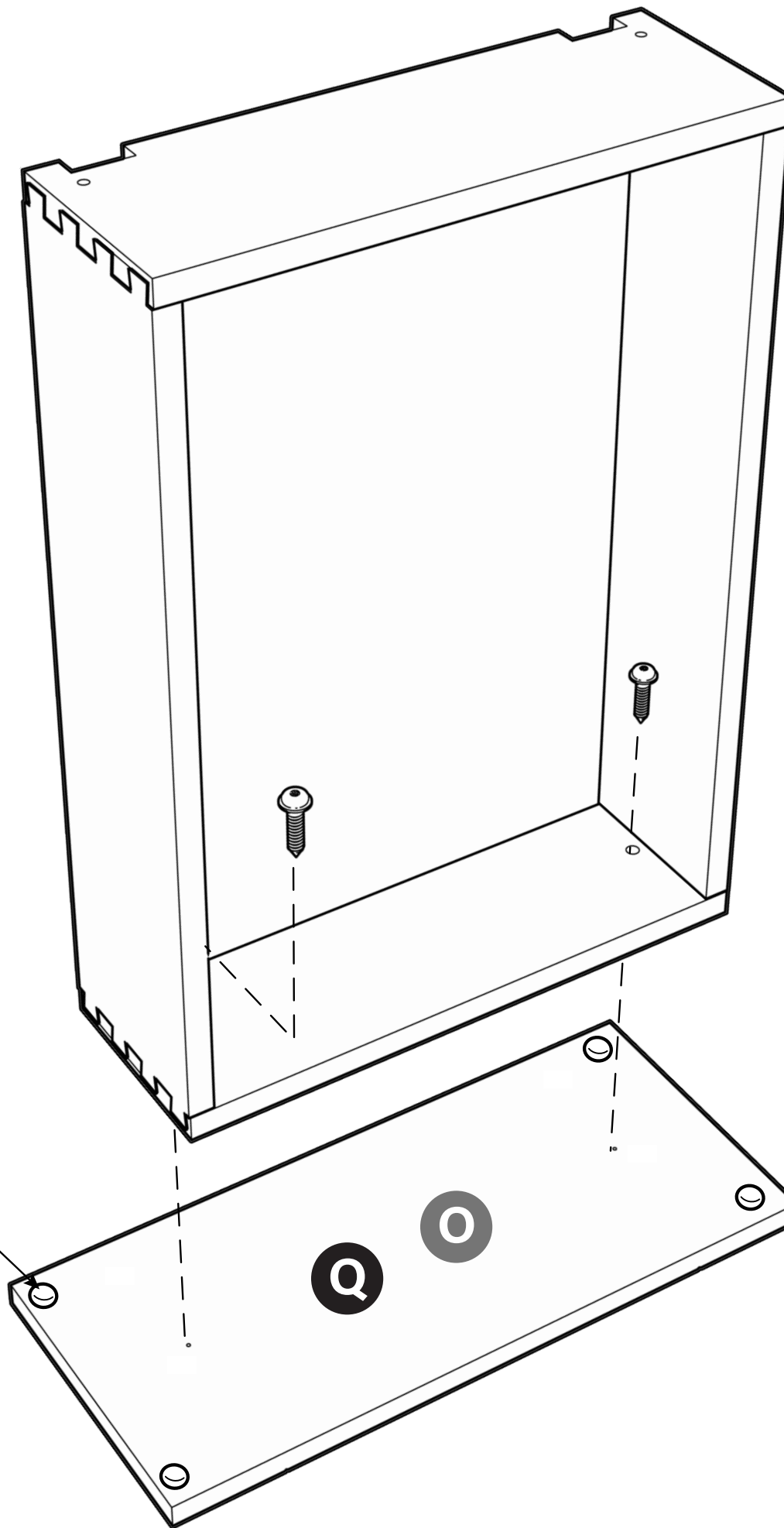

Now, lay the decorative Drawer Fronts (Q and O) face down on a flat surface. If the pilot holes in the back of the drawer front are barely visible, we recommend you enlarge them, by partially inserting and then removing the attachment screws. Position the drawer box over the Drawer Front and insert the two attachment screws thru the oversized holes in the front of the drawer box. Locate the pilot holes in the back of the drawer front and tighten the screws. Do NOT overtighten the screws, or they may strip out!

Finally, install four clear bumpers on the back of each drawer front.

# STEP 20

## HOW TO INSTALL THE 3 DRAWERS

REPEAT THESE STEPS FOR EACH DRAWER

2 Sit the drawer on the runners

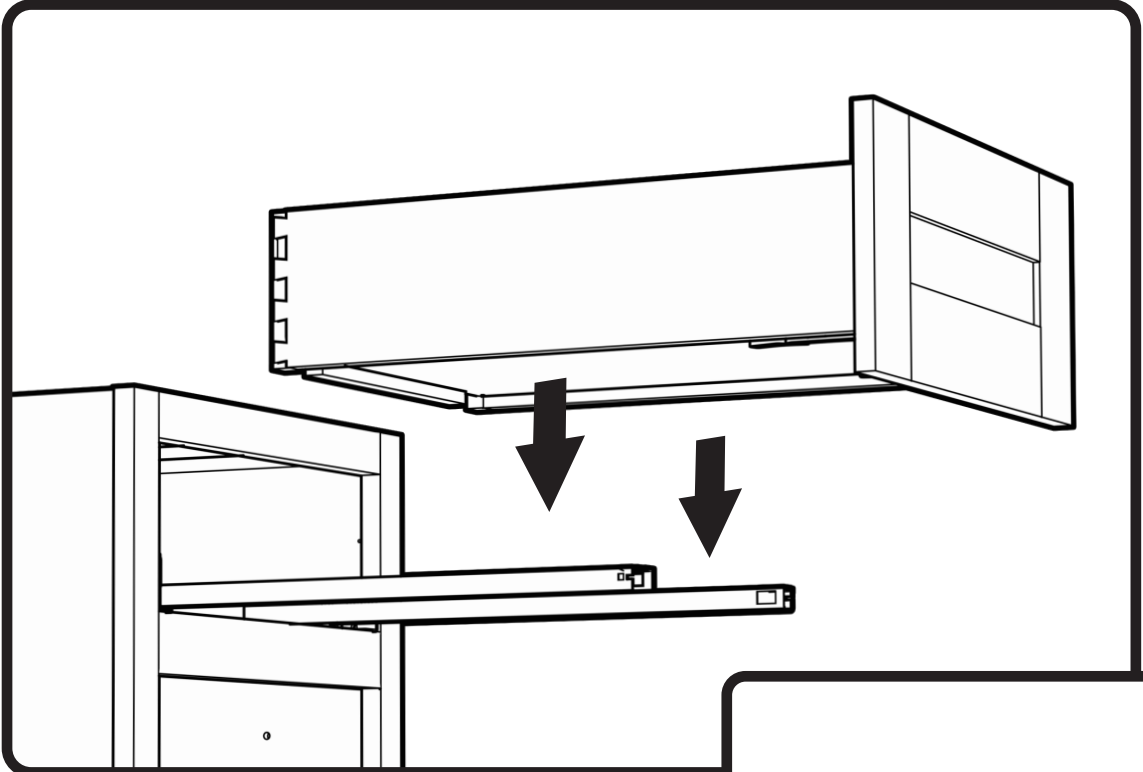

1 Fully extend the Drawer Runners (M)

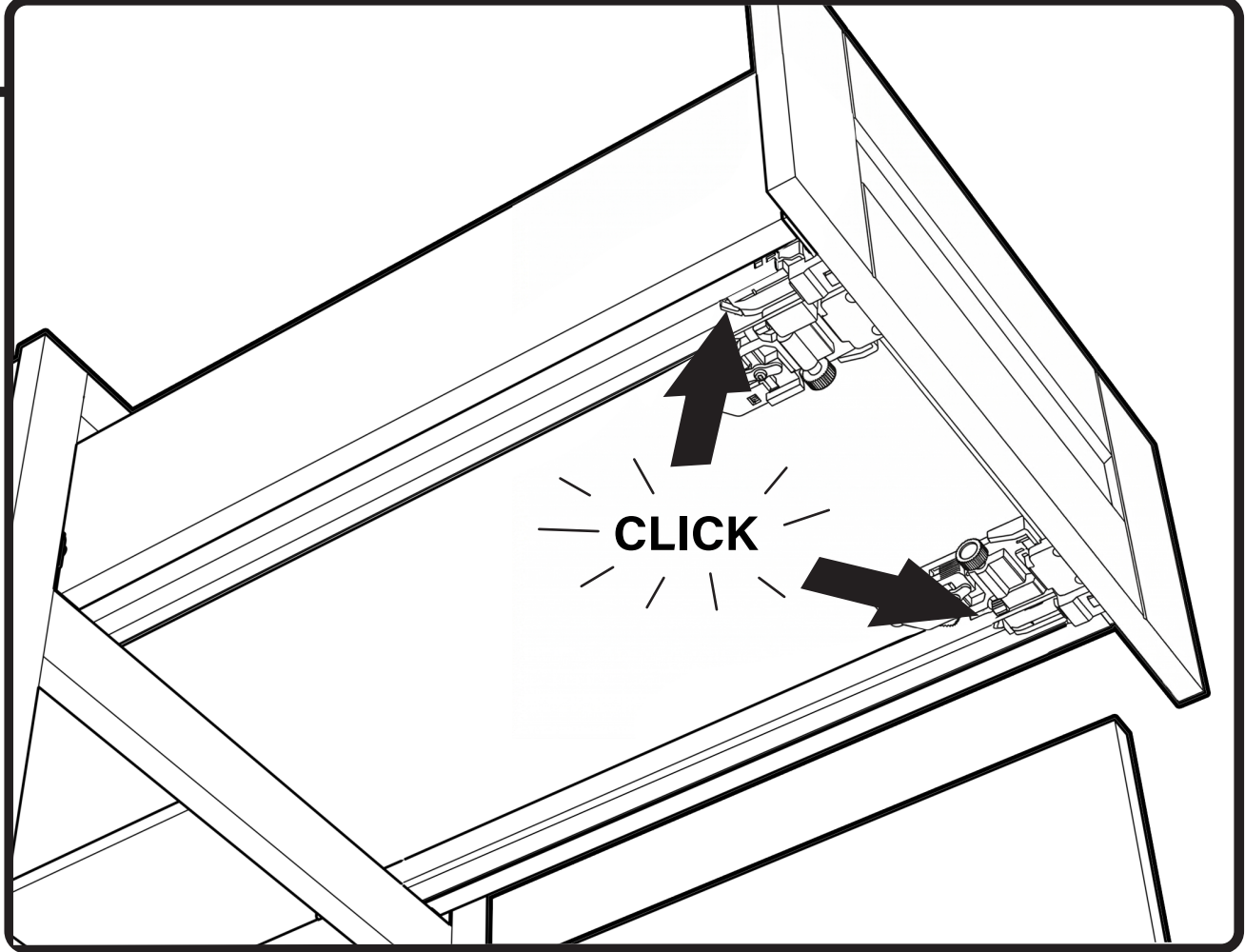
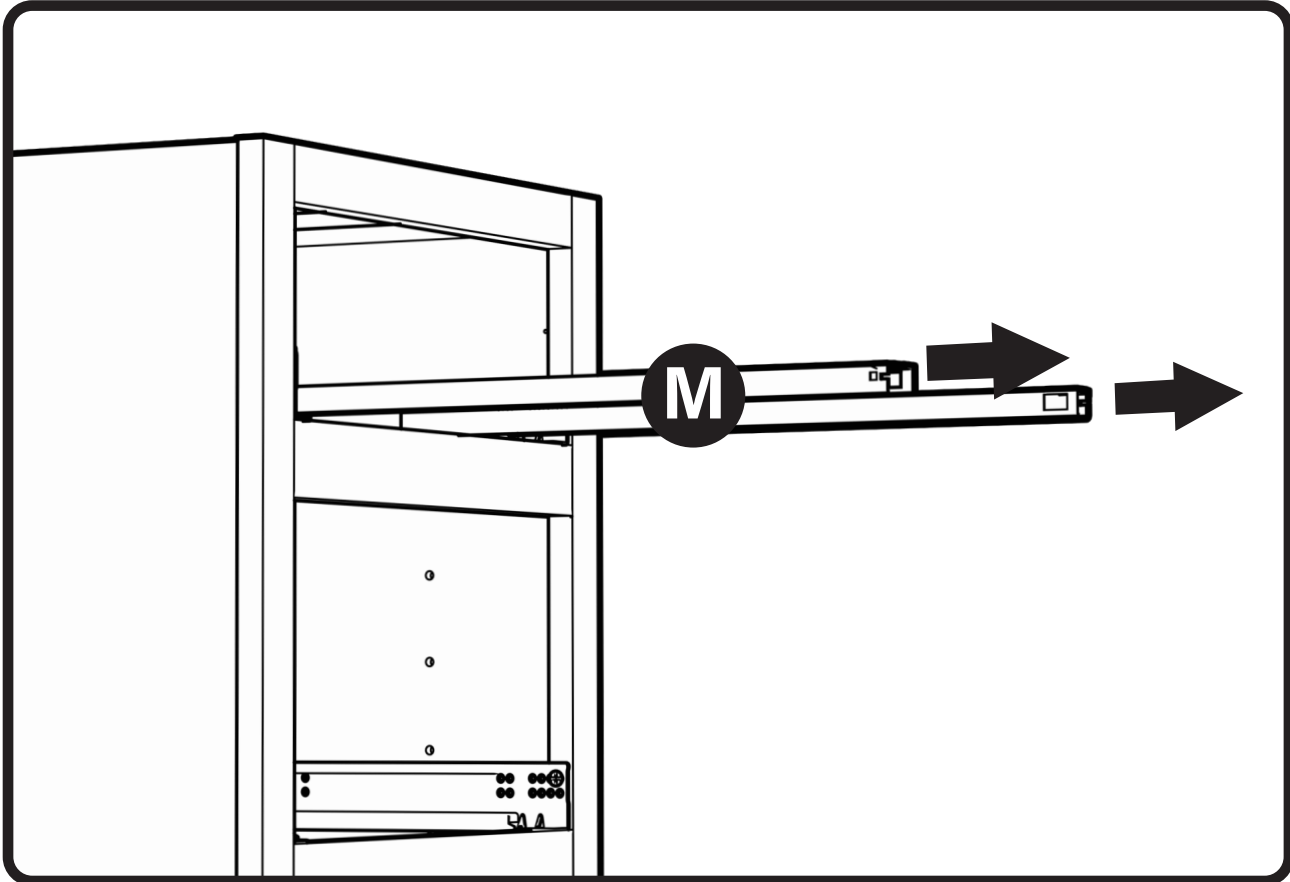

3 Under the drawer, slide the runners forward until they lock into the Locking Devices. Then close drawer to fully engage. The metal prongs on the back of the runner should be inserted in the holes in the back of the drawer

# CONGRATULATIONS



# ENJOY!